

NOTICE!!

These documents have been scanned!

Do not place un-scanned documents beneath this notice!

Do not remove this notice from this file!

GPO Jacket No. 560-102
Print Order 61540
Rise Business Services, LLC
Job=AZ15 6/26/2019



Box Number= AZ15132



Claim Begin-End: AMC363920-AMC363923

1 Initial Receipt



AZ15132-4

AMC363477-AMC364145

United States Department of the Interior
Bureau of Land Management
 BUSINESS & SUPPORT SVCS DIV
 222 N CENTRAL AVE
 PHOENIX, AZ 85004 -2203
 Phone: (602) 417-9200

Receipt	
No:	1003946

Transaction #: 1039509
 Date of Transaction: 12/22/2004

ENTERED INTO COMPUTER
 FEB 02 2005 *FB*

CUSTOMER:	BEVERLY BROWN 10502 CHERRY TREE LN SUN CITY, AZ 85373
-----------	---

LINE #	QTY	DESCRIPTION	REMARKS	UNIT PRICE	TOTAL
1	4.00	LOCATABLE MINERALS / MINING CLAIMS-NEW, UNADJUDI, ONE OR MORE AUTH NO'S / NEW MINING CLAIM LOCATION FEE \$30 (1993) CASES: AMC363920/\$30.00, AMC363921/\$30.00, AMC363922/\$30.00, AMC363923/\$30.00		- n/a -	120.00
2	4.00	LOCATABLE MINERALS / MINING CLAIMS-NEW, UNADJUDI, ONE OR MORE AUTH NO'S / NEW MINING CLAIM SVC CHG \$10 (1930) CASES: AMC363920/\$10.00, AMC363921/\$10.00, AMC363922/\$10.00, AMC363923/\$10.00		- n/a -	40.00
3	4.00	LOCATABLE MINERALS / MINING CLAIMS-NEW, UNADJUDI, ONE OR MORE AUTH NO'S / NEW MINING CLM MAINT FEE \$125 (1993) CASES: AMC363920/\$125.00, AMC363921/\$125.00, AMC363922/\$125.00, AMC363923/\$125.00		- n/a -	500.00
TOTAL:					\$660.00

PAYMENT INFORMATION			
NOTE: Items will appear on credit card statement as "Bureau of Land Management".			
1	AMOUNT:	\$660.00	POSTMARKED: N/A
	TYPE:	CREDIT CARD	RECEIVED: 12/22/2004
	NAME:	BROWN, BEVERLY 10502 CHERRY TREE LN SUN CITY AZ 85373	
	CARD NO:	XXXXXXXXXXXX2786	AUTH CODE: 013099
	NAME ON CARD:	BEVERLY BROWN	
	EXPIRES:	04/30/2005	
	SIGNATURE:		

REMARKS

This receipt was generated by the automated BLM Collections and Billing System and is a paper representation of a portion of the official electronic record contained therein.

*Refund \$120 for overpayment of filing fees (\$30 per claim)
 2/1/05 AB
 Credit card Refund -
 No printout from CBS*

NOTICE!!

These documents have been scanned!

Do not place un-scanned documents beneath this notice!

Do not remove this notice from this file!

GPO Jacket No. 560-102
Print Order 61540
Rise Business Services, LLC
Job=AZ15 6/26/2019



Box Number= AZ15132



Claim Begin-End: AMC363920-AMC363923

2 Correspondence



AZ15132-4

AMC363477-AMC364145

**NO
DOCUMENTS
FOUND**

NO DOCUMENTS FOUND
NO DOCUMENTS FOUND

NOTICE!!

These documents have been scanned!

Do not place un-scanned documents beneath this notice!

Do not remove this notice from this file!

GPO Jacket No. 560-102
Print Order 61540
Rise Business Services, LLC
Job=AZ15 6/26/2019



Box Number= AZ15132



Claim Begin-End: AMC363920-AMC363923

3 Transfers



AZ15132-4

AMC363477-AMC364145

**NO
DOCUMENTS
FOUND**

NO DOCUMENTS FOUND
NO DOCUMENTS FOUND

NOTICE!!

These documents have been scanned!

Do not place un-scanned documents beneath this notice!

Do not remove this notice from this file!

GPO Jacket No. 560-102
Print Order 61540
Rise Business Services, LLC
Job=AZ15 6/26/2019



Box Number= AZ15132



Claim Begin-End: AMC363920-AMC363923

4 Annual Filings



AZ15132-4

AMC363477-AMC364145

353269 277387 356328 353844
 363920 354046 358408 354046
 362141 266964 355276
 351675 268020 355354
 355375

MAINTENANCE FEE PAYMENT

Claimant Name: Beverly Brown/David Kinzenbaur
 Address: 10507 Cherry Tree Ln.
 City: Sun City State: AZ Zip: 85373
 Telephone: C. 623-512-6895 Dave 623-680-2999
 E-mail address: _____
 Signature: _____

RECEIVED
 PHOENIX, ARIZONA
 2018 AUG 21 A 10:59
 BLM
 Date
 Stamp

Check here if this is a change of address.

LINE NO.	AMC NUMBER	CLAIM/SITE NAME	COUNTY RECORDER DATA (If available)	TWP	RNG	SEC
1	353844	Red Rooster	Maricopa	7N	3W	21
2	354046	Catclaw #1	Maricopa	7N	3W	13
3	354047	Catclaw #2	Maricopa	7N	3W	13
4	355277	Catclaw #3	Maricopa	7N	3W	24
5	355354	Catclaw #4	Maricopa	7N	3W	13
6	355375	Catclaw #5	Maricopa	7N	3W	24
7	355376	Catclaw #6	Maricopa	7N	3W	24
8	356330	Catclaw #7	Maricopa	7N	3W	24
9	358409	Havelina #1	Maricopa	7N	3W	22
10	358408	Havelina #2	Maricopa	7N	3W	22

List additional claims on Form MCF114.

No. of Claims*: 32 x \$155 = 4960
 Check No: _____ Init. PET
 Receipt No.: 4240647
 For BLM Use Only

Bureau of Land Management
 Arizona State Office
www.blm.gov/az/

* \$155 per lode mining claim, mill site, or tunnel site; and \$155 for each 20 acres or portion thereof for each placer mining claim.

Form: MCF112
 Revised July 2014

This form is available from the Arizona Geological Survey and may be reproduced.

ENTERED
 AUG 27 2018
 BY: Ran

SUPPLEMENTAL ATTACHMENT

May be used with the following forms for listing additional mining claims:
Check One.

- Affidavit of Performance of Annual Work
- Maintenance Fee Payment
- Notice of Intent to Hold Mining Claims
- Notice of Non-Liability for Labor and Materials Furnished
- Quit claim Deed

BLM
Date
Stamp

RECEIVED
BIM AZ STATE OFFICE
2018 AUG 21 A 10:59
PHOENIX, ARIZONA

LINE NO.	AMC NUMBER	CLAIM/SITE NAME	COUNTY RECORDER DATA (If available)	TWP	RNG	SEC
11	266964	DonKey#1	yav.	8N	3W	35
12	266965	DonKey#2	yav.	8N	3W	35
13	266966	DonKey#3	yav.	8N	3W	35
14	268020	DonKey#4	yav.	8N	3W	35
15	268021	DonKey#5	yav.	8N	3W	35
16	268022	DonKey#6	yav.	8N	3W	35
17	277387	DonKey#7	yav.	8N	3W	35
18	277388	DonKey#8	yav.	8N	3W	35
19	354048	DonKey#9	yav.	8N	3W	35
20	354049	DonKey#10	yav.	8N	3W	35
21	356328	Buzzard#1	yav.	7N	3W	12
22	356329	Buzzard#2	yav.	7N	3W	12
23	362141	Buzzard#3	yav.	7N	3W	12
24	351675	Select#1	yav.	7N	3W	10
25	351676	Select#2	yav.	7N	3W	10
26	351677	Select#3	yav.	7N	3W	10
27	353269	Hog	yav.	8N	3W	36
28	363922	Old Mill#1	yav.	7N	3W	10
29	363923	Old Mill#2	yav.	7N	3W	10

Form MCF114
Revised July 2014

This form is available from the Arizona Geological Survey and may be reproduced.

PHOENIX, ARIZONA

SUPPLEMENTAL ATTACHMENT

May be used with the following forms for listing additional mining claims:

Check One.

- Affidavit of Performance of Annual Work
- Maintenance Fee Payment
- Notice of Intent to Hold Mining Claims
- Notice of Non-Liability for Labor and Materials Furnished
- Quit claim Deed

RECEIVED
BLM AZ STATE OFFICE
PHOENIX, ARIZONA
2018 AUG 21 A 10:59

BLM
Date
Stamp

LINE NO.	AMC NUMBER	CLAIM/SITE NAME	COUNTY RECORDER DATA (If available)	TWP	RNG	SEC
30	355276	Brass Ring	Maricopa	7N	3W	21
31	363920	Catclaw #8	Maricopa	7N	3W	13
32	363921	Catclaw #9	Maricopa	7N	3W	13

Form MCF114
Revised July 2014

This form is available from the Arizona Geological Survey and may be reproduced.

United States Department of the Interior
Bureau of Land Management
 DIV OF LANDS, MINRLS & ENERGY
 ONE N CENTRAL AVE
 PHOENIX, AZ 85004 -4427
 Phone: 602-417-9200

Receipt

No: 4240647

Transaction #: 4356056	
Date of Transaction: 08/21/2018	
CUSTOMER:	
BEVERLY BROWN 10502 W CHERRY TREE LN SUN CITY, AZ 85373-1024 US	

LINE #	QTY	DESCRIPTION	REMARKS	UNIT PRICE	TOTAL
1	1.00	LOCATABLE MINERALS / MINING CLAIMS-NOT NEW-UNADJUD, ONE AUTH NO. ONLY / MINING CLAIM MONEY RECEIVED CASES: AMC353844/\$4960.00	2019 MAINT/32	- n/a -	4960.00
TOTAL:					\$4,960.00

PAYMENT INFORMATION			
NOTE: Items will appear on credit card statement as "Bureau of Land Mgmt CO".			
1	AMOUNT:	2480.00	POSTMARKED: N/A
	TYPE:	CASH	RECEIVED: 08/21/2018
	NAME:	DAVID, KINZENBAW 10502 W CHERRY TREE LN SUN CITY AZ 85373-1024 US	
2	AMOUNT:	2480.00	POSTMARKED: N/A
	TYPE:	CREDIT CARD	RECEIVED: 08/21/2018
	NAME:	BROWN, BEVERLY 10502 W CHERRY TREE LN SUN CITY AZ 85373-1024 US	
	CARD NO:	XXXXXXXXXXXX3407	AUTH CODE: 01664C
	NAME ON CARD:	BEVERLY M BROWN	
	SIGNATURE:		

REMARKS

This receipt was generated by the automated BLM Collections and Billing System and is a paper representation of a portion of the official electronic record contained therein.

United States Department of the Interior
Bureau of Land Management
 DIV OF LANDS, MINRLS & ENERGY
 ONE N CENTRAL AVE
 PHOENIX, AZ 85004 -4427
 Phone: 602-417-9200

Receipt

No: 4240647

Transaction #: 4356056	
Date of Transaction: 08/21/2018	
CUSTOMER:	
BEVERLY BROWN 10502 W CHERRY TREE LN SUN CITY, AZ 85373-1024 US	

LINE #	QTY	DESCRIPTION	REMARKS	UNIT PRICE	TOTAL
1	1.00	LOCATABLE MINERALS / MINING CLAIMS-NOT NEW-UNADJUD, ONE AUTH NO. ONLY / MINING CLAIM MONEY RECEIVED CASES: AMC353844/\$4960.00	2019 MAINT/32	- n/a -	4960.00
TOTAL:					\$4,960.00

PAYMENT INFORMATION			
NOTE: Items will appear on credit card statement as "Bureau of Land Mgmt CO".			
1	AMOUNT:	2480.00	POSTMARKED: N/A
	TYPE:	CASH	RECEIVED: 08/21/2018
	NAME:	DAVID, KINZENBAW 10502 W CHERRY TREE LN SUN CITY AZ 85373-1024 US	
2	AMOUNT:	2480.00	POSTMARKED: N/A
	TYPE:	CREDIT CARD	RECEIVED: 08/21/2018
	NAME:	BROWN, BEVERLY 10502 W CHERRY TREE LN SUN CITY AZ 85373-1024 US	
	CARD NO:	XXXXXXXXXXXX3407	AUTH CODE: 01664C
	NAME ON CARD:	BEVERLY M BROWN	
	SIGNATURE:	<i>Beverly Brown</i>	

REMARKS

This receipt was generated by the automated BLM Collections and Billing System and is a paper representation of a portion of the official electronic record contained therein.

353269

277387

356328

353844

354046

363920

356328

358408

355276

362141

266964

355354

351675

268020

355375

MAINTENANCE FEE PAYMENT

Claimant Name: Beverly Brown/David Kinzenbacher

Address: 10502 Cherry Tree Ln.

City: Sun City State: AZ Zip: 85373

Telephone: C. 623-512-6895 Dave 623-680-2999

E-mail address: _____

Signature: _____

Check here if this is a change of address.

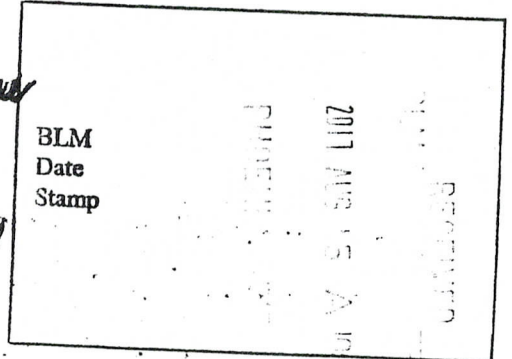

LINE NO.	AMC NUMBER	CLAIM/SITE NAME	COUNTY RECORDER DATA (If available)	TWP	RNG	SEC
1	353844	Red Roaster	Maricopa	7N	3W	21
2	354046	Catclaw #1	Maricopa	7N	3W	13
3	354047	Catclaw #2	Maricopa	7N	3W	13
4	355277	Catclaw #3	Maricopa	7N	3W	24
5	355354	Catclaw #4	Maricopa	7N	3W	13
6	355375	Catclaw #5	Maricopa	7N	3W	24
7	355376	Catclaw #6	Maricopa	7N	3W	24
8	356330	Catclaw #7	Maricopa	7N	3W	24
9	358409	Havelina #1	Maricopa	7N	3W	22
10	358408	Havelina #2	Maricopa	7N	3W	22

List additional claims on Form MCF114.

Bureau of Land Management
Arizona State Office
www.blm.gov/az/

No. of Claims*: 32 x \$155 = 4960
 Check No.: CASH/ARD Init. PETZ
 Receipt No.: 3937486
 For BLM Use Only

* \$155 per lode mining claim, mill site, or tunnel site; and \$155 for each 20 acres or portion thereof for each placer mining claim.

Form: MCF112
Revised July 2014

This form is available from the Arizona Geological Survey and may be reproduced.

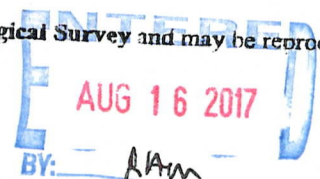

SUPPLEMENTAL ATTACHMENT

May be used with the following forms for listing additional mining claims:

Check One.

- Affidavit of Performance of Annual Work
- Maintenance Fee Payment
- Notice of Intent to Hold Mining Claims
- Notice of Non-Liability for Labor and Materials Furnished
- Quit claim Deed

BLM
Date
Stamp

PHOENIX

2017 AUG 15

RECEIVED

LINE NO.	AMC NUMBER	CLAIM/SITE NAME	COUNTY RECORDER DATA (If available)	TWP	RNG	SEC
11	266964	DonKey #1	yav.	8N	3W	35
12	266965	DonKey #2	yav.	8N	3W	35
13	266966	DonKey #3	yav.	8N	3W	35
14	268020	DonKey #4	yav.	8N	3W	35
15	268021	DonKey #5	yav.	8N	3W	35
16	268022	DonKey #6	yav.	8N	3W	35
17	277387	DonKey #7	yav.	8N	3W	35
18	277388	DonKey #8	yav.	8N	3W	35
19	354048	DonKey #9	yav.	8N	3W	35
20	354049	DonKey #10	yav.	8N	3W	35
21	356328	Buzzard #1	yav.	7N	3W	12
22	356329	Buzzard #2	yav.	7N	3W	12
23	362141	Buzzard #3	yav.	7N	3W	12
24	351675	Select #1	yav.	7N	3W	10
25	351676	Select #2	yav.	7N	3W	10
26	351677	Select #3	yav.	7N	3W	10
27	353269	Hog	yav.	8N	3W	36
28	363922	Old Mill #1	yav.	7N	3W	10
29	363923	Old Mill #2	yav.	7N	3W	10

Form MCF114
Revised July 2014

SUPPLEMENTAL ATTACHMENT

May be used with the following forms for listing additional mining claims:

Check One.

- Affidavit of Performance of Annual Work
- Maintenance Fee Payment
- Notice of Intent to Hold Mining Claims
- Notice of Non-Liability for Labor and Materials Furnished
- Quit claim Deed

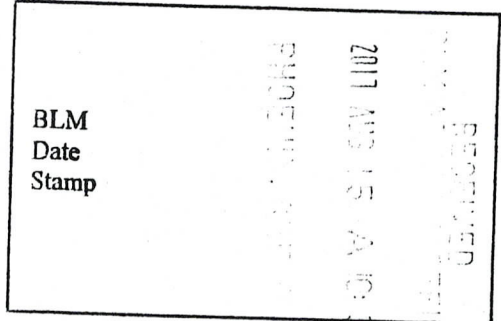

LINE NO.	AMC NUMBER	CLAIM/SITE NAME	COUNTY RECORDER DATA (If available)	TWP	RNG	SEC
30	355276	Brass Ring	Maricopa	7N	3W	21
31	363920	Catelaw #8	Maricopa	7N	3W	13
32	363921	Catelaw #9	Maricopa	7N	3W	13

Form MCF114
Revised July 2014

**United States Department of the Interior
Bureau of Land Management**

DIV OF LANDS, MINRLS & ENERGY

ONE N CENTRAL AVE

PHOENIX, AZ 85004 -4427

Phone: 602-417-9200

Receipt

No:

3937486

Transaction #: 4047112	
Date of Transaction: 08/15/2017	
CUSTOMER:	
BEVERLY BROWN 10502 W CHERRY TREE LN SUN CITY, AZ 85373-1024 US	

LINE #	QTY	DESCRIPTION	REMARKS	UNIT PRICE	TOTAL
1	1.00	LOCATABLE MINERALS / MINING CLAIMS- NOT NEW-UNADJUD, ONE AUTH NO. ONLY / MINING CLAIM MONEY RECEIVED CASES: AMC353844/\$4960.00	2018 MAINT/32	- n/a -	4960.00
TOTAL:					\$4,960.00

PAYMENT INFORMATION			
NOTE: Items will appear on credit card statement as "Bureau of Land Mgmt CO".			
1	AMOUNT:	2500.00	POSTMARKED: N/A
	TYPE:	CASH	RECEIVED: 08/15/2017
	NAME:	BROWN, BEVERLY 10502 W CHERRY TREE LN SUN CITY AZ 85373-1024 US	
2	AMOUNT:	2460.00	POSTMARKED: N/A
	TYPE:	CREDIT CARD	RECEIVED: 08/15/2017
	NAME:	BROWN, BEVERLY 10502 W CHERRY TREE LN SUN CITY AZ 85373-1024 US	
	CARD NO:	XXXXXXXXXXXX3407	AUTH CODE: 05139C
	NAME ON CARD:	BEVERLY M BROWN	
	EXPIRES:	03/2018	
	SIGNATURE:		

REMARKS

266964 355276
 268020 355354
 277387 355375
 351675 356328
 353269 358408
 353844 362141
 354046 363920

RECEIVED
 AZ STATE OFFICE
 2011 AUG 22 A 10: 57
 PHOENIX, ARIZONA

MAINTENANCE FEE PAYMENT

Claimant Name: Beverly Brown/David Kinzenbacher
 Address: 10502 Cherry Tree Ln.
 City: Sun City State: AZ Zip: 85373
 Telephone: C. 623-512-6895 Dave 623-680-2999
 E-mail address: _____
 Signature: Beverly Brown/Dave Kinzenbacher

BLM
 Date
 Stamp

Check here if this is a change of address.

LINE NO.	AMC NUMBER	CLAIM/SITE NAME	COUNTY RECORDER DATA (if available)	TWP	RNG	SEC
1	353844	Red Roaster	Maricopa	7N	3W	21
2	354046	Catclaw #1	Maricopa	7N	3W	13
3	354047	Catclaw #2	Maricopa	7N	3W	13
4	355277	Catclaw #3	Maricopa	7N	3W	24
5	355354	Catclaw #4	Maricopa	7N	3W	13
6	355375	Catclaw #5	Maricopa	7N	3W	24
7	355376	Catclaw #6	Maricopa	7N	3W	24
8	356330	Catclaw #7	Maricopa	7N	3W	24
9	358409	Havelina #1	Maricopa	7N	3W	22
10	358408	Havelina #2	Maricopa	7N	3W	22

List additional claims on Form MCF114.

No. of Claims*: 32 x \$155 = 4960
 Check No: CC-Cash Init. YMC
 Receipt No.: 3636726
 For BLM Use Only

Bureau of Land Management
 Arizona State Office
www.blm.gov/az/

* \$155 per lode mining claim, mill site, or tunnel site; and \$155 for each 20 acres or portion thereof for each placer mining claim.

Form: MCF112
 Revised July 2014

SUPPLEMENTAL ATTACHMENT

May be used with the following forms for listing additional mining claims:

Check One.

- Affidavit of Performance of Annual Work
- Maintenance Fee Payment
- Notice of Intent to Hold Mining Claims
- Notice of Non-Liability for Labor and Materials Furnished
- Quit claim Deed

RECEIVED BLM AZ STATE OFFICE 2016 AUG 22 A 10: 57 PHOENIX, ARIZONA	BLM Date Stamp
---	----------------------

LINE NO.	AMC NUMBER	CLAIM/SITE NAME	COUNTY RECORDER DATA (If available)	TWP	RNG	SEC
11	266964	DonKey#1	yav.	8N	3W	35
12	266965	DonKey#2	yav.	8N	3W	35
13	266966	DonKey#3	yav.	8N	3W	35
14	268020	DonKey#4	yav.	8N	3W	35
15	268021	DonKey#5	yav.	8N	3W	35
16	268022	DonKey#6	yav.	8N	3W	35
17	277387	DonKey#7	yav.	8N	3W	35
18	277388	DonKey#8	yav.	8N	3W	35
19	354048	DonKey#9	yav.	8N	3W	35
20	354049	DonKey#10	yav.	8N	3W	35
21	356328	Buzzard#1	yav.	7N	3W	12
22	356329	Buzzard#2	yav.	7N	3W	12
23	362141	Buzzard#3	yav.	7N	3W	12
24	351675	Select#1	yav.	7N	3W	10
25	351676	Select#2	yav.	7N	3W	10
26	351677	Select#3	yav.	7N	3W	10
27	353269	Hog	yav.	8N	3W	36
28	363922	Old Mill#1	yav.	7N	3W	10
29	363923	Old Mill#2	yav.	7N	3W	10

Form MCF114
Revised July 2014

SUPPLEMENTAL ATTACHMENT

RECEIVED
BLM AZ STATE OFFICE
2016 AUG 22 A 10:51
PHOENIX, ARIZONA
BLM
Date
Stamp

May be used with the following forms for listing additional mining claims:

Check One.

- Affidavit of Performance of Annual Work
- Maintenance Fee Payment
- Notice of Intent to Hold Mining Claims
- Notice of Non-Liability for Labor and Materials Furnished
- Quit claim Deed

LINE NO.	AMC NUMBER	CLAIM/SITE NAME	COUNTY RECORDER DATA (If available)	TWP	RNG	SEC
30	355276	Brass Ring	Maricopa	7N	3W	21
31	363926	Catclaw #8	Maricopa	7N	3W	13
32	363921	Catclaw #9	Maricopa	7N	3W	13

Form MCF114
Revised July 2014

**United States Department of the Interior
Bureau of Land Management
DIV OF LANDS, MINRLS & ENERGY
ONE N CENTRAL AVE
PHOENIX, AZ 85004 -4427
Phone: 602-417-9200**

Receipt

No: 3636726

Transaction #: 3740593	
Date of Transaction: 08/22/2016	
CUSTOMER:	
BEVERLY BROWN 10502 W CHERRY TREE LN SUN CITY, AZ 85373-1024 US	

LINE #	QTY	DESCRIPTION	REMARKS	UNIT PRICE	TOTAL
1	1.00	LOCATABLE MINERALS / MINING CLAIMS- NOT NEW-UNADJUD, ONE AUTH NO. ONLY / MINING CLAIM MONEY RECEIVED CASES: AMC353844/\$4960.00	MAINT 2017/32	- n/a -	4960.00
TOTAL:					\$4,960.00

PAYMENT INFORMATION			
NOTE: Items will appear on credit card statement as "Bureau of Land Mgmt CO".			
1	AMOUNT:	2480.00	POSTMARKED: N/A
	TYPE:	CASH	RECEIVED: 08/22/2016
	NAME:	KINZENBAW, DAVID 13047 N 19TH ST PHOENIX AZ 85022 US	
2	AMOUNT:	2480.00	POSTMARKED: N/A
	TYPE:	CREDIT CARD	RECEIVED: 08/22/2016
	NAME:	BROWN, BEVERLY 10502 W CHERRY TREE LN SUN CITY AZ 85373-1024 US	
	CARD NO:	XXXXXXXXXXXX3407	AUTH CODE: 09305C
	NAME ON CARD:	BEVERLY M BROWN	
	EXPIRES:	03/2018	
	SIGNATURE:		

REMARKS

ENTERED
AUG 24 2016
BY: *[Signature]*

This receipt was generated by the automated BLM Collections and Billing System and is a paper representation of a portion of the official electronic record contained therein.

363920

~~358408~~

358408

353844

355276

~~355276~~

266964

354046

355276

362141

268020

355354

351675

277387

355375

353269

354046

356328

MAINTENANCE FEE PAYMENT

Claimant Name: Beverly Brown / David Kinzenbaw

Address: 10502 Cherry Tree Ln

City: SUN CITY State: AZ Zip: 85373

Telephone: 623-512-6895 Dave C.

E-mail address: bev.brown@centurylink.com

Signature: _____

Check here if this is a change of address.

RECEIVED
BLM AZ STATE OFFICE
2015 AUG 18 A 10:52
PHOENIX, ARIZONA
BLM
Date
Stamp

LINE NO.	AMC NUMBER	CLAIM/SITE NAME	COUNTY RECORDER DATA (If available)	TWP	RNG	SEC
1	353844	Red Rooster	Maricopa	7N	3W	21
2	354046	Catclaw #1	Maricopa	7N	3W	13
3	354047	Catclaw #2	Maricopa	7N	3W	13
4	355277	Catclaw #3	Maricopa	7N	3W	24
5	355354	Catclaw #4	Maricopa	7N	3W	13
6	355375	Catclaw #5	Maricopa	7N	3W	24
7	355376	Catclaw #6	Maricopa	7N	3W	24
8	356330	Catclaw #7	Maricopa	7N	3W	24
9	358409	Havelina #1	Maricopa	7N	3W	22
10	358408	Havelina #2	Maricopa	7N	3W	22

List additional claims on Form MCF114.

Bureau of Land Management
Arizona State Office
www.blm.gov/az/

No. of Claims: 32 x \$155 = 4,960
 Check No.: CCF Cash Unit YML
 Receipt No.: 3369773
 For BLM Use Only

Form: MCF112
Revised July 2009

This form is available from the Arizona Department of Mines and Mineral Resources and may be reproduced.

AUG 24 2015
BY: R Am

SUPPLEMENTAL ATTACHMENT

May be used with the following forms for listing additional mining claims:

Check One.

- Affidavit of Performance of Annual Work
- Maintenance Fee Payment
- Notice of Intent to Hold Mining Claims
- Notice of Non-Liability for Labor and Materials Furnished

RECEIVED
BLM AZ STATE OFFICE
2015 AUG 18 A 10:15
PHOENIX, ARIZONA

BLM
Date
Stamp

LINE NO.	AMC NUMBER	CLAIM/SITE NAME	COUNTY RECORDER DATA (If available)	TWP	RNG	SEC
11	266964	Don Key #1	yav.	8N	3W	35
12	266965	Don Key #2	yav.	8N	3W	35
13	266966	Don Key #3	yav.	8N	3W	35
14	268020	Don Key #4	yav.	8N	3W	35
15	268021	Don Key #5	yav.	8N	3W	35
16	268022	Don Key #6	yav.	8N	3W	35
17	277387	Don Key #7	yav.	8N	3W	35
18	277388	Don Key #8	yav.	8N	3W	35
19	354048	Don Key #9	yav.	8N	3W	35
20	354049	Don Key #10	yav.	8N	3W	35
21	356328	Buzzard #1	yav.	7N	3W	12
22	356329	Buzzard #2	yav.	7N	3W	12
23	362141	Buzzard #3	yav.	7N	3W	12
24	351675	Select # 1	yav.	7N	3W	10
25	351676	Select # 2	yav.	7N	3W	10
26	351677	Select #3	yav.	7N	3W	10
27	353219	Hog	yav.	8N	3W	36
28	363922	Old Mill #1	yav.	7N	3W	10
29	363923	Old mill #2	yav.	7N	3W	10

Form MCF114
Revised June 2005

This form is available from the Arizona Department of Mines & Mineral Resources and may be reproduced.

SUPPLEMENTAL ATTACHMENT

May be used with the following forms for listing additional mining claims:

Check One.

- Affidavit of Performance of Annual Work
- Maintenance Fee Payment
- Notice of Intent to Hold Mining Claims
- Notice of Non-Liability for Labor and Materials Furnished

BLM Date Stamp	PHOENIX, ARIZONA	2015 AUG 18 A 10:52	RECEIVED BLM AZ STATE OFFICE
----------------------	------------------	---------------------	---------------------------------

LINE NO.	AMC NUMBER	CLAIM/SITE NAME	COUNTY RECORDER DATA (If available)	TWP	RANGE	SEC
30	355276	Brass King	Maricopa	7N	3W	21
31	363920	Cate law # 8	Maricopa	7N	3W	13
32	363921	Cate law # 9	Maricopa	7N	3W	13

This form is available from the Arizona Department of Mines & Mineral Resources and may be reproduced.

United States Department of the Interior
Bureau of Land Management
 LANDS/RECREATION & PLANNING
 ONE N CENTRAL AVE
 PHOENIX, AZ 85004 -2203
 Phone: 602-417-9200

Receipt

No: 3369773

Transaction #: 3467931	
Date of Transaction: 08/18/2015	
CUSTOMER:	
BEVERLY BROWN 10502 W CHERRY TREE LN SUN CITY, AZ 85373-1024 US	

LINE #	QTY	DESCRIPTION	REMARKS	UNIT PRICE	TOTAL
1	1.00	LOCATABLE MINERALS / MINING CLAIMS- NOT NEW-UNADJUD, ONE AUTH NO. ONLY / MINING CLAIM MONEY RECEIVED CASES: AMC353844/\$4960.00	MAINT 2016/32	- n/a -	4960.00
TOTAL:					\$4,960.00

PAYMENT INFORMATION			
NOTE: Items will appear on credit card statement as "Bureau of Land Mgmt CO".			
1	AMOUNT:	2480.00	POSTMARKED: N/A
	TYPE:	CASH	RECEIVED: 08/18/2015
	NAME:	BROWN, BEVERLY 10502 W CHERRY TREE LN SUN CITY AZ 85373-1024 US	
2	AMOUNT:	2480.00	POSTMARKED: N/A
	TYPE:	CREDIT CARD	RECEIVED: 08/18/2015
	NAME:	BROWN, BEVERLY 10502 W CHERRY TREE LN SUN CITY AZ 85373-1024 US	
	CARD NO:	XXXXXXXXXXXX3407	AUTH CODE: 05434C
	NAME ON CARD:	BEVERLY M BROWN	
	EXPIRES:	03/2018	
	SIGNATURE:		

REMARKS

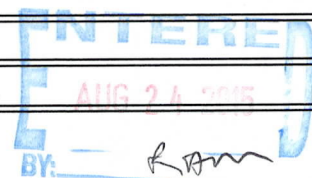

AMC 266964

268020

363920

355276

353844

355354

277387

355375

351675

356328

353269

358408

354046

362141

MAINTENANCE FEE PAYMENT

Claimant Name: Beverly Brown/David Kinzenbaw

Address: 10502 Cherry Tree Ln

City: Sun City State: AZ Zip: 85373

Telephone: C. 623-512-6895 DAVEC.

E-mail address: bev.brown@centurylink.com

Signature: _____

Check here if this is a change of address.

RECEIVED
BLM AZ STATE OFFICE
2014 AUG 19 A 11:05
PHOENIX, ARIZONA
BLM Date Stamp

LINE NO.	AMC NUMBER	CLAIM/SITE NAME	COUNTY RECORDER DATA (If available)	TWP	RNG	SEC
1	353844	Red Rooster	Maricopa	7N	3W	21
2	354046	Catclaw #1	Maricopa	7N	3W	13
3	354047	Catclaw #2	Maricopa	7N	3W	13
4	355277	Catclaw #3	Maricopa	7N	3W	24
5	355354	Catclaw #4	Maricopa	7N	3W	13
6	355375	Catclaw #5	Maricopa	7N	3W	24
7	355376	Catclaw #6	Maricopa	7N	3W	24
8	356330	Catclaw #7	Maricopa	7N	3W	24
9	358409	Havelina #1	Maricopa	7N	3W	22
10	358408	Havelina #2	Maricopa	7N	3W	22

List additional claims on Form MCF114.

Bureau of Land Management
Arizona State Office
www.blm.gov/az/

No. of Claims: 32 x \$155 = 4,960
 Check No. CC e cash Init. 4ME
 Receipt No.: 3105837
 For BLM Use Only

Form: MCF112
Revised July 2009

This form is available from the Arizona Department of Mines and Mineral Resources and may be reproduced.

~~3197710~~

ENTERED
AUG 22 2014
BY: RAM

SUPPLEMENTAL ATTACHMENT

May be used with the following forms for listing additional mining claims:

Check One.

- Affidavit of Performance of Annual Work
- Maintenance Fee Payment
- Notice of Intent to Hold Mining Claims
- Notice of Non-Liability for Labor and Materials Furnished

BLM Date Stamp	PHOENIX, ARIZONA	2014 AUG 19 AM 11:05	RECEIVED IMAZ STATE OFFICE
----------------------	------------------	----------------------	-------------------------------

LINE NO.	AMC NUMBER	CLAIM/SITE NAME	COUNTY RECORDER DATA (If available)	TWP	RNG	SEC
11	266964	Don Key #1	yav.	8N	3W	35
12	266965	Don Key #2	yav.	8N	3W	35
13	266966	Don Key #3	yav.	8N	3W	35
14	268020	Don Key #4	yav.	8N	3W	35
15	268021	Don Key #5	yav.	8N	3W	35
16	268022	Don Key #6	yav.	8N	3W	35
17	277387	Don Key #7	yav.	8N	3W	35
18	277388	Don Key #8	yav.	8N	3W	35
19	354048	Don Key #9	yav.	8N	3W	35
20	354049	Don Key #10	yav.	8N	3W	35
21	356328	Buzzard #1	yav.	7N	3W	12
22	356329	Buzzard #2	yav.	7N	3W	12
23	362141	Buzzard #3	yav.	7N	3W	12
24	351675	Select # 1	yav.	7N	3W	10
25	351676	Select # 2	yav.	7N	3W	10
26	351677	Select #3	yav.	7N	3W	10
27	353269	Hog	yav.	8N	3W	36
28	363922	Old Mill #1	yav.	7N	3W	10
29	363923	Old mill #2	yav.	7N	3W	10

Form MCF114
Revised June 2005

SUPPLEMENTAL ATTACHMENT

May be used with the following forms for listing additional mining claims:

Check One.

- Affidavit of Performance of Annual Work
- Maintenance Fee Payment
- Notice of Intent to Hold Mining Claims
- Notice of Non-Liability for Labor and Materials Furnished

RECEIVED
 LM AZ STATE OFFICE
 PHOENIX, ARIZONA
 2011 AUG 19 A 11:05
 BLM
 Date
 Stamp

LINE NO.	AMC NUMBER	CLAIM/SITE NAME	COUNTY RECORDER DATA (if available)	TWP	RNG	SEC
30	355276	Brass King	Maricopa	7N	3W	21
31	363920	Catclaw#8	Maricopa	7N	3W	13
32	363921	Catclaw#9	Maricopa	7N	3W	13

This form is available from the Arizona Department of Mines & Mineral Resources and may be reproduced.

United States Department of the Interior
Bureau of Land Management
 LANDS/RECREATION & PLANNING
 ONE N CENTRAL AVE
 PHOENIX, AZ 85004 -2203
 Phone: 602-417-9200

INTE
 AUG 22 2014
 BY: *RAM*

Receipt

No: 3105837

Transaction #: 3197101	
Date of Transaction: 08/19/2014	
CUSTOMER:	
BEVERLY BROWN 10502 W CHERRY TREE LN SUN CITY, AZ 85373-1024 US	

LINE #	QTY	DESCRIPTION	REMARKS	UNIT PRICE	TOTAL
1	1.00	LOCATABLE MINERALS / MINING CLAIMS- NOT NEW-UNADJUD, ONE AUTH NO. ONLY / MINING CLAIM MONEY RECEIVED CASES: AMC353844/\$4960.00	MAINT 2015/32	- n/a -	4960.00
TOTAL:					\$4,960.00

PAYMENT INFORMATION				
NOTE: Items will appear on credit card statement as "Bureau of Land Mgmt CO".				
1	AMOUNT:	2480.00	POSTMARKED: N/A	
	TYPE:	CASH	RECEIVED: 08/19/2014	
	NAME:	KINZENBAW, DAVID 10502 W CHERRY TREE LN SUN CITY AZ 85373-1024 US		
2	AMOUNT:	2480.00	POSTMARKED: N/A	
	TYPE:	CREDIT CARD	RECEIVED: 08/19/2014	
	NAME:	BROWN, BEVERLY 10502 W CHERRY TREE LN SUN CITY AZ 85373-1024 US		
	CARD NO:	XXXXXXXXXXXX3407	AUTH CODE: 08143B	
	NAME ON CARD:	BEVERLY M BROWN		
	EXPIRES:	03/2016		
	SIGNATURE:			

REMARKS

This receipt was generated by the automated BLM Collections and Billing System and is a paper representation of a portion of the official electronic record contained therein.

Lead file #s For B. Brown

353844

354046

355276

355354

355375

356328

358408

~~266764~~

268020

277387

354046

362141

351675

353269

363920

MAINTENANCE FEE PAYMENT

Claimant Name: Beverly Brown / David Kinzenbaw
 Address: 10502 Cherry Tree LN
 City: SUN CITY State: AZ Zip: 85373
 Telephone: C. 623-512-6895 Dave C.
 E-mail address: beebrown@centurylink.com
 Signature: Beverly Brown / David R Kinzenbaw

Check here if this is a change of address.

RECEIVED
 BLM AZ STATE OFFICE
 2013 AUG - 6 A 11:47
 PHOENIX, ARIZONA
 BLM
 Date
 Stamp

LINE NO.	AMC NUMBER	CLAIM/SITE NAME	COUNTY RECORDER DATA (If available)	TWP	RNG	SEC
1 -	353844	Red Rooster	Maricopa	7N	3W	21
2	354046	Catclaw #1	Maricopa	7N	3W	13
3 -	354047	Catclaw #2	Maricopa	7N	3W	13
4 -	355277	Catclaw #3	Maricopa	7N	3W	24
5 -	355354	Catclaw #4	Maricopa	7N	3W	13
6	355375	Catclaw #5	Maricopa	7N	3W	24
7	355976	Catclaw #6	Maricopa	7N	3W	24
8 -	356330	Catclaw #7	Maricopa	7N	3W	24
9	358409	Havelina #1	Maricopa	7N	3W	22
10 -	358408	Havelina #2	Maricopa	7N	3W	22

List additional claims on Form MCF114.

Bureau of Land Management
 Arizona State Office
 www.blm.gov/az/

No. of Claims: 32 x \$140 = 4,480
 Check No: CC 5098 Init. ML
 Receipt No.: 3848381
 For BLM Use Only

Form: MCF112
 Revised July 2009

This form is available from the Arizona Department of Mines and Mineral Resources and may be reproduced.

ENTERED INTO COMPUTER
 AUG 13 2013 TS

SUPPLEMENTAL ATTACHMENT

May be used with the following forms for listing additional mining claims:

- Check One.
- Affidavit of Performance of Annual Work
 - Maintenance Fee Payment
 - Notice of Intent to Hold Mining Claims
 - Notice of Non-Liability for Labor and Materials Furnished

BLM
Date
Stamp

RECEIVED
BLM AZ STATE OFFICE
2013 AUG - 6 A 11:47
PHOENIX, ARIZONA

LINE NO.	AMC NUMBER	CLAIM/SITE NAME	COUNTY RECORDER DATA (If available)	TWP	RNG	SEC
11	266964	Don Key #1	yav.	8N	3W	35
12	266965	Don Key #2	yav.	8N	3W	35
13	266966	Don Key #3	yav.	8N	3W	35
14	268020	Don Key #4	yav.	8N	3W	35
15	268021	Don Key #5	yav.	8N	3W	35
16	268022	Don Key #6	yav.	8N	3W	35
17	277387	Don Key #7	yav.	8N	3W	35
18	277388	Don Key #8	yav.	8N	3W	35
19	354048	Don Key #9	yav.	8N	3W	35
20	354049	Don Key #10	yav.	8N	3W	35
21	356328	Buzzard #1	yav.	7N	3W	12
22	356329	Buzzard #2	yav.	7N	3W	12
23	362141	Buzzard #3	yav.	7N	3W	12
24	351675	Select #1	yav.	7N	3W	10
25	351676	Select #2	yav.	7N	3W	10
26	351677	Select #3	yav.	7N	3W	10
27	353269	Hog	yav.	8N	3W	36
28	363922	Old mill #1	yav.	7N	3W	10
29	363923	Old mill #2	yav.	7N	3W	10

Form MCF114
Revised June 2005

SUPPLEMENTAL ATTACHMENT

May be used with the following forms for listing additional mining claims:

Check One.

- Affidavit of Performance of Annual Work
- Maintenance Fee Payment
- Notice of Intent to Hold Mining Claims
- Notice of Non-Liability for Labor and Materials Furnished

BLM
Date
Stamp

RECEIVED
BLM AZ STATE OFFICE
PHOENIX, ARIZONA
2013 AUG -6 A 11:11

LINE NO.	AMC NUMBER	CLAIM/SITE NAME	COUNTY RECORDER DATA (If available)	TWP	RNG	SEC
- 30	355276	Brass King	Maricopa	7N	3W	21
31	363920	Catclaw#8	Maricopa	7N	3W	13
- 32	363921	Catclaw#9	Maricopa	7N	3W	13

This form is available from the Arizona Department of Mines & Mineral Resources and may be reproduced.

United States Department of the Interior

Bureau of Land Management

LANDS/RECREATION & PLANNING

ONE N CENTRAL AVE

PHOENIX, AZ 85004 -2203

Phone: 602-417-9200

Receipt

No:

2848381

Transaction #: 2934077

Date of Transaction: 08/06/2013

CUSTOMER:

BEVERLY BROWN
10502 W CHERRY TREE LN
SUN CITY, AZ 85373-1024 US

LINE #	QTY	DESCRIPTION	REMARKS	UNIT PRICE	TOTAL
1	1.00	LOCATABLE MINERALS / MINING CLAIMS-NOT NEW-UNADJUD, ONE AUTH NO. ONLY / MINING CLAIM MONEY RECEIVED CASES: AMC353844/\$4480.00	MAINT 2014/32	- n/a -	4480.00
TOTAL:					\$4,480.00

PAYMENT INFORMATION

NOTE: Items will appear on credit card statement as "Bureau of Land Mgmt CO".

1	AMOUNT:	2240.00	POSTMARKED:	N/A
	TYPE:	CASH	RECEIVED:	08/06/2013
	NAME:	KINZENBAW, DAVID 13047 N 19TH ST PHOENIX AZ 85022 US		
2	AMOUNT:	2240.00	POSTMARKED:	N/A
	TYPE:	CREDIT CARD	RECEIVED:	08/06/2013
	NAME:	BROWN, BEVERLY 10502 W CHERRY TREE LN SUN CITY AZ 85373-1024 US		
	CARD NO:	XXXXXXXXXXXX8512	AUTH CODE:	01714C
	NAME ON CARD:	BEVERLY M BROWN		
	EXPIRES:	06/2015		
	SIGNATURE:			

REMARKS

This receipt was generated by the automated BLM Collections and Billing System and is a paper representation of a portion of the official electronic record contained therein.

Amc 353844
 353269
 351675
 354046
 355276
 355354

Amc 355375
 356328
 358408
 362141
 363920

MAINTENANCE FEE PAYMENT

Claimant Name: Beverly Brown / David Kinzenbaw
 Address: 10502 Cherry Tree LN
 City: Sun City State: AZ Zip: 85373
 Telephone: H 623-972-0057 - C. 623 512 6895
 E-mail address: bevbrown@centurylink.net
 Signature: Beverly Brown / David R. Kinzenbaw

Check here if this is a change of address.

RECEIVED
 BLM AZ STATE OFFICE
 2012 AUG - 7 A 10:47
 PHOENIX, ARIZONA

BLM
 Date
 Stamp

LINE NO.	AMC NUMBER	CLAIM/SITE NAME	COUNTY RECORDER DATA (If available)	TWP	RNG	SEC
1	353844	Red Rooster	Maricopa	7N	3W	21
2	354046	Catclaw # 1	Maricopa	7N	3W	13
3	354047	Catclaw # 2	Maricopa	7N	3W	13
4	355277	Catclaw # 3	Maricopa	7N	3W	24
5	355354	Catclaw # 4	Maricopa	7N	3W	13
6	355375	Catclaw # 5	Maricopa	7N	3W	24
7	355376	Catclaw # 6	Maricopa	7N	3W	24
8	356330	Catclaw # 7	Maricopa	7N	3W	24
9	358409	Havelina # 1	Maricopa	7N	3W	22
10	358408	Havelina # 2	Maricopa	7N	3W	22

List additional claims on Form MCF114.

No. of Claims: 22 x \$140 = 3,080
 Check No: CC & Cash thit. JME
 Receipt No.: 2624523
 For BLM Use Only

Bureau of Land Management
 Arizona State Office
 www.blm.gov/az/

Form: MCF112
 Revised July 2009

This form is available from the Arizona Department of Mines and Mineral Resources and may be reproduced.

ENTERED INTO COMPUTER

8/21/12 AT

SUPPLEMENTAL ATTACHMENT

May be used with the following forms for listing additional mining claims:

Check One.

- Affidavit of Performance of Annual Work
- Maintenance Fee Payment
- Notice of Intent to Hold Mining Claims
- Notice of Non-Liability for Labor and Materials Furnished

RECEIVED
 BLM AZ STATE OFFICE
 2012 AUG - 7 A 10:47
 PHOENIX, ARIZONA
 BLM
 Date
 Stamp

LINE NO.	AMC NUMBER	CLAIM/SITE NAME	COUNTY RECORDER DATA (If available)	TWP	RNG	SEC
11	356328	Buzzard#1	yav.	7N	3W	12
12	356329	Buzzard#2	yav.	7N	3W	12
13	362141	Buzzard#3	yav.	7N	3W	12
14	351675	Select#1	yav.	7N	3W	10
15	351676	Select#2	yav.	7N	3W	10
16	351677	Select#3	yav.	7N	3W	10
17	353269	Hog	yav.	8N	3W	36
18	363922	Old Mill#1	yav.	7N	3W	10
19	363923	Old Mill#2	yav.	7N	3W	10
20	355276	Brass Ring	Maricopa	7N	3W	21
21	363920	Catclaw#8	Maricopa	7N	3W	13
22	363921	Catclaw#9	Maricopa	7N	3W	13

Form MCF114
 Revised June 2005

United States Department of the Interior
 Bureau of Land Management
 LANDS/RECREATION & PLANNING
 ONE N CENTRAL AVE
 PHOENIX, AZ 85004 -2203
 Phone: 602-417-9200



Receipt

No:

2624523

Transaction #: 2704920	
Date of Transaction: 08/07/2012	
CUSTOMER:	
BEVERLY BROWN 10502 W CHERRY TREE LN SUN CITY, AZ 85373-1024 US	

LINE #	QTY	DESCRIPTION	REMARKS	UNIT PRICE	TOTAL
1	1.00	LOCATABLE MINERALS / MINING CLAIMS-NOT NEW-UNADJUD, ONE AUTH NO. ONLY / MINING CLAIM MONEY RECEIVED CASES: AMC353844/\$3080.00	<i>Mount 2013/22</i>	- n/a -	3080.00
TOTAL:					\$3,080.00

PAYMENT INFORMATION			
NOTE: Items will appear on credit card statement as "Bureau of Land Mgmt CO".			
1	AMOUNT:	1540.00	POSTMARKED: N/A
	TYPE:	CASH	RECEIVED: 08/07/2012
	NAME:	KINZENBAW, DAVID 13047 N 19TH ST PHOENIX AZ 85022 US	
2	AMOUNT:	1540.00	POSTMARKED: N/A
	TYPE:	CREDIT CARD	RECEIVED: 08/07/2012
	NAME:	BROWN, BEVERLY 10502 W CHERRY TREE LN SUN CITY AZ 85373-1024 US	
	CARD NO:	XXXXXXXXXXXX8512	AUTH CODE: 04732C
	NAME ON CARD:	BEVERLY M BROWN	
	EXPIRES:	06/2015	
	SIGNATURE:		

REMARKS

This receipt was generated by the automated BLM Collections and Billing System and is a paper representation of a portion of the official electronic record contained therein. Lead Amc #s (PB)

Amc 353844 Amc 356328 Amc 363920
 354046 358408
 355276 362141
 355354 351675
 355375 353269

AMC 355276 AMC 353844
 AMC 363920 AMC 354046
 AMC 353269 AMC 355276
 AMC 351675 AMC 355354
 AMC 362141 AMC 355375
 AMC 358408 AMC 356328

MAINTENANCE FEE PAYMENT

Claimant Name: Beverly Brown/David Katzenbaw
 Address: 10502 Cherry Tree Ln.
 City: Sun City State: AZ Zip: 85313
 Telephone: 4623-972-0057 @ 6235126895
 E-mail address: _____
 Signature: Beverly Brown
 Check here if this is a change of address.

RECEIVED
 MARICOPA STATE OFFICE
 PHOENIX, ARIZONA
 2011 AUG 23 A 10:53
 BLM
 Date
 Stamp

LINE NO.	AMC NUMBER	CLAIM/SITE NAME	COUNTY RECORDER DATA (If available)	TWP	RNG	SEC
1	353844	Red Rooster	Maricopa	7N	3W	21
2	354046	Catclaw #1	Maricopa	7N	3W	13
3	354047	Catclaw #2	Maricopa	7N	3W	13
4	355277	Catclaw #3	Maricopa	7N	3W	24
5	355354	Catclaw #4	Maricopa	7N	3W	13
6	355375	Catclaw #5	Maricopa	7N	3W	24
7	355376	Catclaw #6	Maricopa	7N	3W	24
8	356330	Catclaw #7	Maricopa	7N	3W	24
9	358409	Havelina #1	Maricopa	7N	3W	22
10	358408	Havelina #2	Maricopa	7N	3W	22

List additional claims on Form MCF114.

No. of Claims: 22 x \$140 = 3,080
 Check No: CC-cash Init. MB
 Receipt No.: 2412707
 For BLM Use Only

Bureau of Land Management
 Arizona State Office
 www.blm.gov/az/

SEP 1 2011
 Cm

Form: MCF112
 Revised July 2009

SUPPLEMENTAL ATTACHMENT

May be used with the following forms for listing additional mining claims:

Check One.

- Affidavit of Performance of Annual Work
- Maintenance Fee Payment
- Notice of Intent to Hold Mining Claims
- Notice of Non-Liability for Labor and Materials Furnished

BLM
Date
Stamp

RECEIVED
STATE OFFICE
PHOENIX, ARIZONA
2011 AUG 23 A 10:53

LINE NO.	AMC NUMBER	CLAIM/SITE NAME	COUNTY RECORDER DATA (If available)	TWP	RNG	SEC
11	356328	Buzzard #1	yav.	7N	3W	12
12	356329	Buzzard #2	yav.	7N	3W	12
13	362141	Buzzard #3	yav.	7N	3W	12
14	351675	Select #1	yav.	7N	3W	10
15	351676	Select #2	yav.	7N	3W	10
16	351677	Select #3	yav.	7N	3W	10
17	353269	Hog	yav.	8N	3W	36
18	363922	Old mill #1	yav.	7N	3W	10
19	363923	Old mill #2	yav.	7N	3W	10
20	355276	Brass Ring	Maricopa	7N	3W	21
21	363920	Catclaw #8	Maricopa	7N	3W	13
22	363921	Catclaw #9	Maricopa	7N	3W	13

Form MCF114
Revised June 2005

This form is available from the Arizona Department of Mines & Mineral Resources and may be reproduced.

United States Department of the Interior
 Bureau of Land Management
 LANDS/RECREATION & PLANNING
 ONE N CENTRAL AVE
 PHOENIX, AZ 85004 -2203
 Phone: 602-417-9200

Receipt

No: 2412707

Transaction #: 2488058	
Date of Transaction: 08/23/2011	
CUSTOMER:	
BEVERLY BROWN 10502 W CHERRY TREE LN SUN CITY, AZ 85373-1024 US	

LINE #	QTY	DESCRIPTION	REMARKS	UNIT PRICE	TOTAL
1	1.00	LOCATABLE MINERALS / MINING CLAIMS-NOT NEW-UNADJUD, ONE AUTH NO. ONLY / MINING CLAIM MONEY RECEIVED CASES: AMC353844/\$3080.00	MAINT 2012/22	- n/a -	3080.00
TOTAL:					\$3,080.00

PAYMENT INFORMATION					
NOTE: Items will appear on credit card statement as "Bureau of Land Mgmt CO".					
1	AMOUNT:	1540.00	POSTMARKED:	N/A	
	TYPE:	CASH	RECEIVED:	08/23/2011	
	NAME:	KIZENBAW, DAVID 13047 N 19TH ST PHOENIX AZ 85022 US			
2	AMOUNT:	1540.00	POSTMARKED:	N/A	
	TYPE:	CREDIT CARD	RECEIVED:	08/23/2011	
	NAME:	BROWN, BEVERLY 10502 W CHERRY TREE LN SUN CITY AZ 85373-1024 US			
	CARD NO:	XXXXXXXXXXXX5819	AUTH CODE:	02015C	
	NAME ON CARD:	BEVERLY M BROWN			
	EXPIRES:	06/2012			
	SIGNATURE:				

REMARKS

This receipt was generated by the automated BLM Collections and Billing System and is a paper representation of a portion of the official electronic record contained therein.

Receipt: 2191433

AMC	353844
AMC	354046
AMC	355276
AMC	355375
AMC	355354
AMC	356328
AMC	358408
AMC	362141
AMC	351675
AMC	353269
AMC	363920

~~AMC 353844~~
~~AMC 354046~~
~~AMC 355276~~
~~AMC 355375~~
~~AMC 355354~~
~~AMC 356328~~

MAINTENANCE FEE PAYMENT

Claimant Name: Beverly Brown/David Kinzenbaw
 Address: 10502 Cherry Tree Ln.
 City: Sun City State: AZ Zip: 85373 ✓
 Telephone: 623-972-0057
 E-mail address: _____
 Signature: Beverly Brown
 Check here if this is a change of address.

RECEIVED
 BLM AZ STATE OFFICE
 PHOENIX, ARIZONA
 2010 AUG 16 A 10:59
 BLM Date Stamp

LINE NO.	AMC NUMBER	CLAIM/SITE NAME	COUNTY RECORDER DATA (If available)	TWP	RNG	SEC
1	353844	Red Rooster	Maricopa ✓			
2	354046	Catclaw #1	Maricopa			
3	354047	Catclaw #2	Maricopa			
4	355277	Catclaw #3	Maricopa			
5	355354	Catclaw #4	Maricopa			
6	355375	Catclaw #5	Maricopa			
7	355376	Catclaw #6	Maricopa			
8	356330	Catclaw #7	Maricopa			
9	358409	Havalina #1	Maricopa			
10	358408	Havalina #2	Maricopa			

List additional claims on Form MCF114.

Bureau of Land Management
 Arizona State Office
 www.blm.gov/az/

No. of Claims: 22 x \$140 = 3,080
 Check No: CASH Init. SC
 Receipt No.: 2191433
 For BLM Use Only

CC 1,540
 1,540
3,080

Form: MCF112
 Revised July 2009

This form is available from the Arizona Department of Mines and Mineral Resources and may be reproduced.

10/50

SUPPLEMENTAL ATTACHMENT

May be used with the following forms for listing additional mining claims:

Check One.

- Affidavit of Performance of Annual Work
- Maintenance Fee Payment
- Notice of Intent to Hold Mining Claims
- Notice of Non-Liability for Labor and Materials Furnished

RECEIVED
 BLM AZ STATE OFFICE
 200 AUG 16 A 10:59
 PHOENIX, ARIZONA
 BLM
 Date
 Stamp

LINE NO.	AMC NUMBER	CLAIM/SITE NAME	COUNTY RECORDER DATA (If available)	TWP	RNG	SEC
11	356328	Buzzard #1	yav.			
12	356329	Buzzard #2	yav.			
13	362141	Buzzard #3	yav.			
14	351675	Select #1	yav.			
15	351676	Select #2	yav.			
16	351677	Select #3	yav.			
17	353269	Hog	yav.			
18	363922	Old Mill #1	yav.			
19	363923	Old Mill #2	yav.			
20	355276	Bross King	Maricopa			
21	363920	CateLaw #8	Maricopa			
22	363921	CateLaw #9	Maricopa			

ENTERED INTO COMPUTER
 AUG 24 2010

Form MCF114
 Revised June 2005

13/20

United States Department of the Interior
 Bureau of Land Management
 LANDS/RECREATION & PLANNING
 ONE N CENTRAL AVE
 PHOENIX, AZ 85004 -2203
 Phone:

Receipt

No: 2191433

Transaction #: 2261191		ENTERED INTO COMPUTER
Date of Transaction: 08/16/2010		
CUSTOMER:	BEVERLY BROWN 10502 W CHERRY TREE LN SUN CITY, AZ 85373-1024 US	AUG 24 2010

LINE #	QTY	DESCRIPTION	REMARKS	UNIT PRICE	TOTAL
1	1.00	LOCATABLE MINERALS / MINING CLAIMS-NOT NEW-UNADJUD, ONE AUTH NO. ONLY / MINING CLAIM MONEY RECEIVED CASES: AMC353844/\$3080.00	MAINT (22) 2011	- n/a -	3080.00
TOTAL:					\$3,080.00

PAYMENT INFORMATION					
NOTE: Items will appear on credit card statement as "Bureau of Land Mgmt CO".					
1	AMOUNT:	1540.00	POSTMARKED:	N/A	
	TYPE:	CASH	RECEIVED:	08/16/2010	
	NAME:	BROWN, BEVERLY 10502 W CHERRY TREE LN SUN CITY AZ 85373-1024 US			
2	AMOUNT:	1540.00	POSTMARKED:	N/A	
	TYPE:	CREDIT CARD	RECEIVED:	08/16/2010	
	NAME:	BROWN, BEVERLY 10502 W CHERRY TREE LN SUN CITY AZ 85373-1024 US			
	CARD NO:	XXXXXXXXXXXX2786	AUTH CODE:	07634B	
	NAME ON CARD:	BEVERLY BROWN			
	EXPIRES:	05/2012			
	SIGNATURE:				

REMARKS

This receipt was generated by the automated BLM Collections and Billing System and is a paper representation of a portion of the official electronic record contained therein.

Receipt
1980474

AMC 351675 AMC 355276 AMC 356328
 AMC 353269 AMC 355375 AMC 358408
 AMC 354046 AMC 356140 AMC 363920

MAINTENANCE FEE PAYMENT

Claimant Name: Beverly Brown/David Kinzenbaw
 Address: 10502 Cherry Tree LN
 City: Sun City State: AZ Zip: 85373
 Telephone: 623-972-0057
 E-mail address: _____
 Signature: Beverly Brown

Check here if this is a change of address.

RECEIVED
 AZ STATE OFFICE
 AUG 18 A 11:08
 DENIX, ARIZONA
 BLM
 Date
 Stamp

LINE NO.	AMC NUMBER	CLAIM/SITE NAME	COUNTY RECORDER DATA (If available)	TWP	RNG	SEC
✓ 1	353844	Red Rooster	Maricopa			
✓ 2	354046	Catclaw #1	Maricopa			
✓ 3	354047	Catclaw #2	Maricopa			
✓ 4	*355277	Catclaw #3	Maricopa			
✓ 5	355354	Catclaw #4	Maricopa			
✓ 6	355375	Catclaw #5	Maricopa			
✓ 7	355376	Catclaw #6	Maricopa			
✓ 8	356330	Catclaw #7	Maricopa			
✓ 9	358409	Havalina #1	Maricopa			
✓ 10	358408	Havalina #2	Maricopa			

List additional claims on Form MCF114.

Bureau of Land Management
 Arizona State Office
www.az.blm.gov

No. of Claims: 22 ¹⁴⁰ × \$125 = 3080
 Check No: CC/cash Init. FMC
 Receipt No.: 1980491
 For BLM Use Only

Form: MCF112
 Revised July 2005

This form is available from the Arizona Department of Mines and Mineral Resources and may be reproduced.



SUPPLEMENTAL ATTACHMENT

May be used with the following forms for listing additional mining claims:

Check One.

- Affidavit of Performance of Annual Work
- Maintenance Fee Payment
- Notice of Intent to Hold Mining Claims
- Notice of Non-Liability for Labor and Materials Furnished

RECEIVED
 PLM AZ STATE OFFICE
 2009 AUG 18 A 11: 08
 Date
 Stamp PHOENIX, ARIZONA

LINE NO.	AMC NUMBER	CLAIM/SITE NAME	COUNTY RECORDER DATA (If available)	TWP	RNG	SEC
✓ 11	356398	Buzzard#1	yav.			
✓ 12	356399	Buzzard#2	yav.			
✓ 13	362141	Buzzard#3	yav.			
✓ 14	351675	Select #1	yav			
✓ 15	351676	Select #2	yav			
✓ 16	351677	Select #3	yav			
✓ 17	353269	Hog	yav.			
✓ 18	363922	Old mill #1	yav.			
✓ 19	363923	old mill #2	yav.			
✓ 20	355276	Brass Ring	Maricopa			
✓ 21	363920	Catclaw#8	Maricopa			
✓ 22	363921	Catclaw#9	Maricopa			

Form MCF114
 Revised June 2005

United States Department of the Interior

Bureau of Land Management
 BUSINESS & SUPPORT SVCS DIV
 ONE N CENTRAL AVE SUITE 800
 PHOENIX, AZ 85004 -4427
 Phone: (602) 417-9200

Receipt

No:

1980491

Transaction #: 2044530	
Date of Transaction: 08/18/2009	
CUSTOMER:	BEVERLY BROWN 10502 W CHERRY TREE LN SUN CITY, AZ 85373-1024 US

LINE #	QTY	DESCRIPTION	REMARKS	UNIT PRICE	TOTAL
1	1.00	LOCATABLE MINERALS / MINING CLAIMS-NOT NEW-UNADJUD, ONE AUTH NO. ONLY / MINING CLAIM MONEY RECEIVED CASES: AMC353844/\$3080.00	MAINT 2010/22	- n/a -	3080.00
TOTAL:					\$3,080.00

PAYMENT INFORMATION					
NOTE: Items will appear on credit card statement as "Bureau of Land Mgmt CO".					
1	AMOUNT:	1540.00	POSTMARKED:	N/A	
	TYPE:	CASH	RECEIVED:	08/18/2009	
	NAME:	BROWN, BEVERLY 10502 W CHERRY TREE LN SUN CITY AZ 85373-1024 US			
2	AMOUNT:	1540.00	POSTMARKED:	N/A	
	TYPE:	CREDIT CARD	RECEIVED:	08/18/2009	
	NAME:	BROWN, BEVERLY 10502 W CHERRY TREE LN SUN CITY AZ 85373-1024 US			
	CARD NO:	XXXXXXXXXXXX5819	AUTH CODE:	02064C	
	NAME ON CARD:	BEVERLY M BROWN			
	EXPIRES:	06/2012			
	SIGNATURE:				

REMARKS

This receipt was generated by the automated BLM Collections and Billing System and is a paper representation of a portion of the official electronic record contained therein.

AMC 363920 AMC 353844
 AMC 354046 AMC 355276
 AMC 355354 AMC 355375
 AMC 356328 AMC 358408
 AMC 362141 AMC 351675
 AMC 353269

MAINTENANCE FEE PAYMENT

Claimant Name: Beverly Brown / David Kinzenbaw
 Address: 10502 Cherry Tree Ln.
 City: SUN City State: AZ Zip: 85373
 Telephone: 602 972-0057
 E-mail address: _____
 Signature: Beverly Brown

RECEIVED
 B.L.M. AZ STATE OFFICE
 PHOENIX, ARIZONA
 2008 AUG 12 A 10:34
 BLM Date Stamp

Check here if this is a change of address.

LINE NO.	AMC NUMBER	CLAIM/SITE NAME	COUNTY RECORDER DATA (If available)	TWP	RNG	SEC
1	353844	Red Rooster	Maricopa	7N	3W	21
2	354046	Catclaw #1	Maricopa	7N	3W	13
3	354047	Catclaw #2	Maricopa	7N	3W	13
4	355277	Catclaw #3	Maricopa	7N	3W	24
5	355354	Catclaw #4	Maricopa	7N	3W	13
6	355375	Catclaw #5	Maricopa	7N	3W	24
7	355376	Catclaw #6	Maricopa	7N	3W	24
8	356330	Catclaw #7	Maricopa	7N	3W	24
9	358409	Havelina #1	Maricopa	7N	3W	22
10	358408	Havelina #2	Maricopa	7N	3W	22

List additional claims on Form MCF114.

No. of Claims: 22 x \$125 = 2,750
 Check No: Cash check for unit. JMC
 Receipt No.: 1759109
 For BLM Use Only

Bureau of Land Management
 Arizona State Office
www.az.blm.gov

Form: MCF112
 Revised July 2005

This form is available from the Arizona Department of Mines and Mineral Resources and may be reproduced.

ENTERED INTO COMPUTER

SEP 03 08
 SEP 03 08

SUPPLEMENTAL ATTACHMENT

May be used with the following forms for listing additional mining claims:
Check One.

- Affidavit of Performance of Annual Work
- Maintenance Fee Payment
- Notice of Intent to Hold Mining Claims
- Notice of Non-Liability for Labor and Materials Furnished

RECEIVED
BLM. AZ STATE OFFICE
2008 AUG 12 A 10 39
PHOENIX, ARIZONA
BLM
Date
Stamp

LINE NO.	AMC NUMBER	CLAIM/SITE NAME	COUNTY RECORDER DATA (If available)	TWP	RMS	SEC
11	356328	Buzzard #1	yav.	7N	3W	12
12	356329	Buzzard #2	yav.	7N	3W	12
13	362141	Buzzard #3	yav.	7N	3W	12
14	351675	Select #1	yav.	7N	3W	10
15	351676	Select #2	yav.	7N	3W	10
16	351677	Select #3	yav.	7N	3W	10
17	353269	Hog	yav.	8N	3W	36
18	363922	Old Mill #1	yav.	7N	3W	10
19	363923	Old Mill #2	yav.	7N	3W	10
20	355276	Brass Ring	Maricopa	7N	3W	21
21	363920	Catclaw #8	Maricopa	7N	3W	13
22	363921	Catclaw #9	Maricopa	7N	3W	13

Form MCF114
Revised June 2005

This form is available from the Arizona Department of Mines & Mineral Resources and may be reproduced.

United States Department of the Interior
 Bureau of Land Management
 BUSINESS & SUPPORT SVCS DIV
 ONE N CENTRAL AVE SUITE 800
 PHOENIX, AZ 85004 -4427
 Phone: (602) 417-9200

Receipt

No:

1759109

Transaction #: 1816595	
Date of Transaction: 08/12/2008	
CUSTOMER:	DAVID KINZENBAW BEVERLY BROWN 10502 CHERRY TREE LN SUN CITY, AZ 85373

LINE #	QTY	DESCRIPTION	REMARKS	UNIT PRICE	TOTAL
1	1.00	LOCATABLE MINERALS / MINING CLAIMS-NOT NEW-UNADJUD, ONE AUTH NO. ONLY / MINING CLAIM MONEY RECEIVED (455) CASES: AMC353844/\$2750.00	MAINT 2009/22	- n/a -	2750.00
TOTAL:					\$2,750.00

PAYMENT INFORMATION					
1	AMOUNT:	\$1,375.00	POSTMARKED:	N/A	
	TYPE:	CASH	RECEIVED:	08/12/2008	
	NAME:	BEVERLY BROWN KINZENBAW, DAVID 10502 CHERRY TREE LN SUN CITY AZ 85373			
2	AMOUNT:	\$1,375.00	POSTMARKED:	N/A	
	TYPE:	CHECK	RECEIVED:	08/12/2008	
	CHECK NO:	4070			
	NAME:	BEVERLY BROWN KINZENBAW, DAVID 10502 CHERRY TREE LN SUN CITY AZ 85373			

REMARKS

This receipt was generated by the automated BLM Collections and Billing System and is a paper representation of a portion of the official electronic record contained therein.

LEAD FILE NUMBERS:

AMC 353844	356328	363920
354046	362141	
355276	351675	
355354	353269	
355375	362917	
356328	363923	
358408	355276	

LEAD AMC SERIAL NUMBER	AMC SERIAL NUMBER(S)	NUMBER OF CLAIM(S)
353844		1
354046	354047, 46	2
355276	355277	2
355354		1
355375	355376, 75	2
356328	356330	1
358408	358408, 09	2
356328	356328, 29	2
362141		1
351675	351675, 76, 77	3
353269		1
362917	363922	1
363923		1
355276		1
363920	363920	2
363921		

ENTERED INTO COMPUTER

8/21/07 DJJ

AMC 353844
 354046
 355276
 356328
 358408
 356328

MAINTENANCE FEE PAYMENT

Claimant Name: Beverly Brown / David Kizenban
 Address: 10502 Cherry Tree Ln
 City: Sun City State: AZ Zip: 85373
 Telephone: 623-972-0057
 E-mail address: _____
 Signature: Beverly Brown

RECEIVED
 BLM, AZ STATE OFFICE
 2007 AUG 13 A 10:46
 PHOENIX, ARIZONA
 BLM Date Stamp

Check here if this is a change of address.

LINE NO.	AMC NUMBER	CLAIM/SITE NAME	COUNTY RECORDER DATA (If available)	TWP	RNG	SEC
1	353 844	Red Rooster	Maricopa	7N	3W	21
2 L	354 046	Catclaw #1	Maricopa	7N	3W	13
3 L	354 047	Catclaw #2	Maricopa	7N	3W	13
4	355 277	Catclaw #3	Maricopa	7N	3W	24
5 L	355 354	Catclaw #4	Maricopa	7N	3W	13
6 L	355 375	Catclaw #5	Maricopa	7N	3W	24
7 "	355 376	Catclaw #6	Maricopa	7N	3W	24
8	356 330	Catclaw #7	Maricopa	7N	3W	24
9	358 409	Havalina #1	Maricopa	7N	3W	22
10	358 408	Havalina #2	Maricopa	7N	3W	22

List additional claims on Form MCF114.

Bureau of Land Management
 Arizona State Office
www.az.blm.gov

No. of Claims: 22 x \$125 = 2,750
 Check No: CC Cash Unit AMC
 Receipt No.: 154278
 For BLM Use Only

Form: MCF112
 Revised July 2005

SUPPLEMENTAL ATTACHMENT

May be used with the following forms for listing additional mining claims:

Check One.

- Affidavit of Performance of Annual Work
- Maintenance Fee Payment
- Notice of Intent to Hold Mining Claims
- Notice of Non-Liability for Labor and Materials Furnished

RECEIVED
 BLM, AZ STATE OFFICE
 2001 AUG 13 A 10:46
 PHOENIX, ARIZONA
 BLM
 Date
 Stamp

LINE NO.	AMC NUMBER	CLAIM/SITE NAME	COUNTY RECORDER DATA (If available)	TWP	RNG	SEC
L 11	356328	Buzzard #1	yav.	7N	3W	12
" 12	356329	Buzzard #2	yav.	7N	3W	12
L 13	362141	Buzzard #3	yav.	7N	3W	12
L 14	351675	Select #1	yav.	7N	3W	10
" 15	351676	Select #2	yav.	7N	3W	10
" 16	351677	Select #3	yav.	7N	3W	10
L 17	353269	Hog	yav.	8N	3W	36
362917 L 18	363922	Old mill #1	yav.	7N	3W	10
L 19	363923	Old mill #2	yav.	7N	3W	10
L 20	355276	Brass Ring	Maricopa	7N	3W	21
L 21	363920	Catclaw #8	Maricopa	7N	3W	13
" 22	363921	Catclaw #9	Maricopa	7N	3W	13

Form MCF114
Revised June 2005

United States Department of the Interior
Bureau of Land Management
 BUSINESS & SUPPORT SVCS DIV
 ONE N CENTRAL AVE SUITE 800
 PHOENIX, AZ 85004 -4427
 Phone: (602) 417-9200

Receipt

No: 1542178

Transaction #: 1593527	
Date of Transaction: 08/13/2007	
CUSTOMER:	BEVERLY BROWN DAVID KIZENBAW 10502 CHERRY TREE LN SUN CITY, AZ 85373

LINE #	QTY	DESCRIPTION	REMARKS	UNIT PRICE	TOTAL
1	1.00	LOCATABLE MINERALS / MINING CLAIMS- NOT NEW-UNADJUD, ONE AUTH NO. ONLY / MINING CLAIM MONEY RECEIVED (455) CASES: AMC353844/\$2750.00	<i>Hand 22</i>	- n/a -	2750.00
TOTAL:					\$2,750.00

PAYMENT INFORMATION			
NOTE: Items will appear on credit card statement as "Bureau of Land Management".			
1	AMOUNT:	\$1,375.00	POSTMARKED: N/A
	TYPE:	CASH	RECEIVED: 08/13/2007
	NAME:	DAVID KIZENBAW BROWN, BEVERLY 10502 CHERRY TREE LN SUN CITY AZ 85373	
2	AMOUNT:	\$1,375.00	POSTMARKED: N/A
	TYPE:	CREDIT CARD	RECEIVED: 08/13/2007
	NAME:	DAVID KIZENBAW BROWN, BEVERLY 10502 CHERRY TREE LN SUN CITY AZ 85373	
	CARD NO:	XXXXXXXXXXXX2786	AUTH CODE: 00052Z
	NAME ON CARD:	BEVERLY M BROWN	
	EXPIRES:	04/30/2009	
	SIGNATURE:		

LEAD FILE NUMBERS:

AMC 353844

356328

363920

354046

362141

355276

351675

355354

353269

355375

362917

356328

363923

358408

~~355276~~

LEAD AMC SERIAL NUMBER	AMC SERIAL NUMBER(S)	NUMBER OF CLAIM(S)
353844		1
354046	354047, 46	2
355276	355277	2
355354		1
355375	355376, 75	2
356328	356330	1
358408	358408, 09	2
356328	356328, 29	2
362141		1
351675	351675, 76, 77	3
353269		1
362917	363922	1
363923		1
355276		≠
363920	363920	2
363921		

ENTERED INTO COMPUTER

8/21/07 DJJ

AMC 353844
 354046
 355276
 356328
 358408
 356328

MAINTENANCE FEE PAYMENT

Claimant Name: Beverly Brown / David Kizenbau
 Address: 10502 Cherry Tree LN
 City: SUN City State: AZ Zip: 85373
 Telephone: 623-972-0057
 E-mail address: _____
 Signature: Beverly Brown

RECEIVED
 BLM, AZ STATE OFFICE
 2007 AUG 13 A 10:46
 PHOENIX, ARIZONA
 BLM Date Stamp

Check here if this is a change of address.

LINE NO.	AMC NUMBER	CLAIM/SITE NAME	COUNTY RECORDER DATA (If available)	TWP	RNG	SEC
1	353 844	Red Rooster	Maricopa	7N	3W	21
2 L	354 046	Catclaw #1	Maricopa	7N	3W	13
3 L	354 047	Catclaw #2	Maricopa	7N	3W	13
4	355 277	Catclaw #3	Maricopa	7N	3W	24
5 L	355 354	Catclaw #4	Maricopa	7N	3W	13
6 L	355 375	Catclaw #5	Maricopa	7N	3W	24
7 "	355 376	Catclaw #6	Maricopa	7N	3W	24
8	356 330	Catclaw #7	Maricopa	7N	3W	24
9	358 409	Havalina #1	Maricopa	7N	3W	22
10	358 408	Havalina #2	Maricopa	7N	3W	22

List additional claims on Form MCF114.

Bureau of Land Management
 Arizona State Office
www.az.blm.gov

No. of Claims: 22 x \$125 = 2,750
 Check No: CC Cash Unit: AMC
 Receipt No.: 154278
 For BLM Use Only

Form: MCF112
 Revised July 2005

This form is available from the Arizona Department of Mines and Mineral Resources and may be reproduced.

SUPPLEMENTAL ATTACHMENT

May be used with the following forms for listing additional mining claims:

Check One.

- Affidavit of Performance of Annual Work
- Maintenance Fee Payment
- Notice of Intent to Hold Mining Claims
- Notice of Non-Liability for Labor and Materials Furnished

RECEIVED
BLM, AZ STATE OFFICE
2007 AUG 13 A 10:46
PHOENIX, ARIZONA

BLM
Date
Stamp

LINE NO.	AMC NUMBER	CLAIM/SITE NAME	COUNTY RECORDER DATA (If available)	TWP	RNG	SEC
L 11	356328	Buzzard #1	yav.	7N	3W	12
" 12	356329	Buzzard #2	yav.	7N	3W	12
L 13	362141	Buzzard #3	yav.	7N	3W	12
L 14	351675	Select #1	yav.	7N	3W	10
" 15	351676	Select #2	yav.	7N	3W	10
" 16	351677	Select #3	yav.	7N	3W	10
L 17	353269	Hog	yav.	8N	3W	36
362917 L 18	363922	Old mill #1	yav.	7N	3W	10
L 19	363923	Old mill #2	yav.	7N	3W	10
L 20	355276	Brass Ring	Maricopa	7N	3W	21
L 21	363920	Catclaw #8	Maricopa	7N	3W	13
" 22	363921	Catclaw #9	Maricopa	7N	3W	13

Form MCF114
Revised June 2005

This form is available from the Arizona Department of Mines & Mineral Resources and may be reproduced.

United States Department of the Interior
Bureau of Land Management
 BUSINESS & SUPPORT SVCS DIV
 ONE N CENTRAL AVE SUITE 800
 PHOENIX, AZ 85004 -4427
 Phone: (602) 417-9200

Receipt

No: 1542178

Transaction #: 1593527	
Date of Transaction: 08/13/2007	
CUSTOMER:	BEVERLY BROWN DAVID KIZENBAW 10502 CHERRY TREE LN SUN CITY, AZ 85373

LINE #	QTY	DESCRIPTION	REMARKS	UNIT PRICE	TOTAL
1	1.00	LOCATABLE MINERALS / MINING CLAIMS- NOT NEW-UNADJUD, ONE AUTH NO. ONLY / MINING CLAIM MONEY RECEIVED (455) CASES: AMC353844/\$2750.00	<i>Land 22</i>	- n/a -	2750.00
TOTAL:					\$2,750.00

PAYMENT INFORMATION			
NOTE: Items will appear on credit card statement as "Bureau of Land Management".			
1	AMOUNT:	\$1,375.00	POSTMARKED: N/A
	TYPE:	CASH	RECEIVED: 08/13/2007
	NAME:	DAVID KIZENBAW BROWN, BEVERLY 10502 CHERRY TREE LN SUN CITY AZ 85373	
2	AMOUNT:	\$1,375.00	POSTMARKED: N/A
	TYPE:	CREDIT CARD	RECEIVED: 08/13/2007
	NAME:	DAVID KIZENBAW BROWN, BEVERLY 10502 CHERRY TREE LN SUN CITY AZ 85373	
	CARD NO:	XXXXXXXXXXXX2786	AUTH CODE: 00052Z
	NAME ON CARD:	BEVERLY M BROWN	
	EXPIRES:	04/30/2009	
	SIGNATURE:		

AMC 351675
 353269
 353844

354046
 355276
 355354

355375
 356328
 358408

362141
 363920

MAINTENANCE FEE PAYMENT

Claimant Name: Beverly Brown / David Kinzenbaw
 Address: 10502 Cherry Tree LN
 City: Sun City State: AZ Zip: 85373
 Telephone: 623-972-0057
 E-mail address: _____
 Signature: Beverly Brown

RECEIVED
 B.L.M. AZ STATE OFFICE
 2006 AUG - 8 A 11: 07
 PHOENIX, ARIZONA
 BLM
 Date
 Stamp

Check here if this is a change of address.

LINE NO.	AMC NUMBER	CLAIM/SITE NAME	COUNTY RECORDER DATA (If available)	TWP	RNG	SEC
1	353844	Red Rooster	Maricopa	7N	3W	21
2	354046	Catclaw #1	Maricopa	7N	3W	13
3	354047	Catclaw #2	Maricopa	7N	3W	13
4	355277	Catclaw #3	Maricopa	7N	3W	24
5	355354	Catclaw #4	Maricopa	7N	3W	13
6	355375	Catclaw #5	Maricopa	7N	3W	24
7	355376	Catclaw #6	Maricopa	7N	3W	24
8	356330	Catclaw #7	Maricopa	7N	3W	24
9	358409	Havalina #1	Maricopa	7N	3W	22
10	358408	Havalina #2	Maricopa	7N	3W	22

List additional claims on Form MCF114.

Bureau of Land Management
 Arizona State Office
www.az.blm.gov

No. of Claims: 22 x \$125 = 2,750 --
 Check No.: #3644/cash Unit. HMC
 Receipt No.: 1329770
 For BLM Use Only

Form: MCF112
 Revised July 2005

This form is available from the Arizona Department of Mines and Mineral Resources and may be reproduced.

ENTERED INTO COMPUTER
 AUG 11 2006 PB

SUPPLEMENTAL ATTACHMENT

May be used with the following forms for listing additional mining claims:

Check One.

- Affidavit of Performance of Annual Work
- Maintenance Fee Payment
- Notice of Intent to Hold Mining Claims
- Notice of Non-Liability for Labor and Materials Furnished

RECEIVED
B.L.M. AZ STATE OFFICE
2006 AUG - 8 A 11:08
PHOENIX, ARIZONA

BLM
Date
Stamp

LINE NO.	AMC NUMBER	CLAIM/SITE NAME	COUNTY RECORDER DATA (If available)	TWP	RNG	SEC
11	356328	Buzzard #1	yav	7N	3W	12
12	356329	Buzzard #2	yav	7N	3W	12
13	362141	Buzzard #3	yav.	7N	3W	12
14	351675	Select #1	yav.	7N	3W	10
15	351676	Select #2	yav.	7N	3W	10
16	351677	Select #3	yav.	7N	3W	10
17	353269	Hog	yav.	8N	3W	36
18	363922	Old Mill #1	yav.	7N	3W	10
19	363923	Old Mill #2	yav.	7N	3W	10
ENTERED INTO COMPUTER AUG 11 2006 RB						

SUPPLEMENTAL ATTACHMENT

May be used with the following forms for listing additional mining claims:

Check One.

- Affidavit of Performance of Annual Work
- Maintenance Fee Payment
- Notice of Intent to Hold Mining Claims
- Notice of Non-Liability for Labor and Materials Furnished

BLM
Date
Stamp

RECEIVED
BLM, AZ STATE OFFICE

PHOENIX, ARIZONA

2006 AUG - 8 A 11:08

LINE NO.	AMC NUMBER	CLAIM/SITE NAME	COUNTY RECORDER DATA (If available)	TWP	RNG	SEC
20	355276	Brass Ring	Maricopa	7N	3W	21
21	363920	Catclaw #8	Maricopa	7N	3W	13
22	363921	Catclaw #9	Maricopa	7N	3W	13
ENTERED INTO COMPUTER AUG 11 2006 PB						

This form is available from the Arizona Department of Mines & Mineral Resources and may be reproduced.

United States Department of the Interior
Bureau of Land Management
 BUSINESS & SUPPORT SVCS DIV
 ONE N CENTRAL AVE
 PHOENIX, AZ 85004 -2203
 Phone: (602) 417-9200

Receipt

No: 1329770

Transaction #: 1374773		ENTERED INTO COMPUTER AUG 11 2006 PB
Date of Transaction: 08/08/2006		
CUSTOMER:	BEVERLY BROWN DAVID KINZENBAW 10502 CHERRY TREE LN SUN CITY, AZ 85373	

LINE #	QTY	DESCRIPTION	REMARKS	UNIT PRICE	TOTAL
1	1.00	LOCATABLE MINERALS / MINING CLAIMS-NOT NEW-UNADJUD, ONE AUTH NO. ONLY / MINING CLAIM MONEY RECEIVED (455) CASES: AMC353844/\$2750.00	MAINT 2007/22	- n/a -	2750.00
TOTAL:					\$2,750.00

PAYMENT INFORMATION					
1	AMOUNT:	\$1,375.00	POSTMARKED:	N/A	
	TYPE:	CASH	RECEIVED:	08/08/2006	
	NAME:	DAVID KINZENBAW BROWN, BEVERLY 10502 CHERRY TREE LN SUN CITY AZ 85373			
2	AMOUNT:	\$1,375.00	POSTMARKED:	N/A	
	TYPE:	CHECK	RECEIVED:	08/08/2006	
	CHECK NO:	3644			
	NAME:	DAVID KINZENBAW BROWN, BEVERLY 10502 CHERRY TREE LN SUN CITY AZ 85373			

REMARKS	

This receipt was generated by the automated BLM Collections and Billing System and is a paper representation of a portion of the official electronic record contained therein.

MAINTENANCE FEE PAYMENT

Claimant Name: Beverly Brown
 Address: 10502 Cherry Tree Ln.
 City: SUN CITY State: AZ Zip: 85373
 Telephone: 623 972 0057
 E-mail address: _____
 Signature: Beverly Brown

Check here if this is a change of address.

RECEIVED
 B.L.M. AZ STATE OFFICE
 PHOENIX, ARIZONA
 2005 AUG 30 P 2:37
 BLM
 Date
 Stamp

LINE NO.	AMC NUMBER	CLAIM/SITE NAME	COUNTY RECORDER DATA (if available)	TWP	RNG	SEC
1	266 964	DONKEY #1	yav.	8N	3W	35
2	266 965	DONKEY #2	yav	8N	3W	35
3	266 966	DONKEY #3	yav.	8N	3W	35
4	268 020	DONKEY #4	yav	8N	3W	35
5	268 021	DONKEY #5	yav.	8N	3W	35
6	268 022	DONKEY #6	yav.	8N	3W	35
7	277 387	DONKEY #7	yav.	8N	3W	35
8	277 388	DONKEY #8	yav.	8N	3W	35
9	354 048	DONKEY #9	yav	8N	3W	35
10	354. 049	DONKEY #10	yav	8N	3W	35

List additional claims on Form MCF114.

Bureau of Land Management
 Arizona State Office
www.az.blm.gov

No. of Claims: 19 x \$125 = 2,375
 Check No: CR #3467 Init. TMC
 #1001 E CC 1141627
 Receipt No.: _____
 For BLM Use Only

Form: MCF112
 Revised July 2005

This form is available from the Arizona Department of Mines and Mineral Resources and may be reproduced.

RE 9/14/05

SUPPLEMENTAL ATTACHMENT

May be used with the following forms for listing additional mining claims:

Check One.

- Affidavit of Performance of Annual Work
- Maintenance Fee Payment
- Notice of Intent to Hold Mining Claims
- Notice of Non-Liability for Labor and Materials Furnished

BLM Date Stamp	RECEIVED B. M. AZ STATE OFFICE 2005 AUG 30 P 2: 37 PHOENIX, ARIZONA
----------------------	--

LINE NO.	AMC NUMBER	CLAIM/SITE NAME	COUNTY RECORDER DATA (If available)	TWP	RNG	SEC
11	356 328	Buzzard #1	Yav.	7N	3W	12
12	356 329	Buzzard #2	Yav.	7N	3W	12
13	362 141	Buzzard #3	Yav.	7N	3W	12
14	351 675	Select # 1	Yav.	7N	3W	10
15	351 676	Select # 2	Yav.	7N	3W	10
16	351 677	Select # 3	Yav.	7N	3W	10
17	353 269	Hog	Yav.	8N	3W	36
18	363 922	Old Mill #1	Yav.	7N	3W	10
19	363 923	Old Mill #2	Yav.	7N	3W	10

Form MCF114
Revised June 2005

This form is available from the Arizona Department of Mines & Mineral Resources and may be reproduced.

RE 9/19/05

MAINTENANCE FEE PAYMENT

Claimant Name: Beverly Brown/David Kinzenbaw
 Address: 10502 Cherry Tree LN
 City: SUN CITY State: AZ Zip: 85373
 Telephone: 623-972-0057
 E-mail address: _____
 Signature: Beverly Brown

RECEIVED
 B.L.M. AZ STATE OFFICE
 2005 AUG 30 P 2:38
 PHOENIX, ARIZONA
 BLM
 Date
 Stamp

Check here if this is a change of address.

LINE NO.	AMC NUMBER	CLAIM/SITE NAME	COUNTY RECORDER DATA (if available)	TWP	RNG	SEC
1	353844	RED ROOSTER	MARICOPA	7N	3W	21
2	354046	CAT CLAW #1	MARICOPA	7N	3W	13
3	354047	CAT CLAW #2	MARICOPA	7N	3W	13
4	355277	CAT CLAW #3	MARICOPA	7N	3W	24
5	355354	CAT CLAW #4	MARICOPA	7N	3W	13
6	355375	CAT CLAW #5	MARICOPA	7N	3W	24
7	355376	CAT CLAW #6	MARICOPA	7N	3W	24
8	356330	CAT CLAW #7	MARICOPA	7N	3W	24
9	358409	HAAVALINA #1	MARICOPA	7N	3W	22
10	358408	HAAVALINA #2	MARICOPA	7N	3W	22

List additional claims on Form MCF114.

No. of Claims: 13 x \$125 = 1,625
 Check No: CD #3467 Init. TMC
#1001 & CC 1141627
 Receipt No.: _____
 For BLM Use Only

Bureau of Land Management
 Arizona State Office
www.az.blm.gov

Form: MCF112
 Revised July 2005

This form is available from the Arizona Department of Mines and Mineral Resources and may be reproduced.

RE 9/14/05

SUPPLEMENTAL ATTACHMENT

May be used with the following forms for listing additional mining claims:

Check One.

- Affidavit of Performance of Annual Work
- Maintenance Fee Payment
- Notice of Intent to Hold Mining Claims
- Notice of Non-Liability for Labor and Materials Furnished

RECEIVED
BLM. AZ STATE OFFICE
PHOENIX, ARIZONA
2005 AUG 30 P 2:38

BLM
Date
Stamp

LINE NO.	AMC NUMBER	CLAIM/SITE NAME	COUNTY RECORDER DATA (if available)	TWP	RNG	SEC
11	355276	BRASS RING	MARICOPA	7N	3W	21
12	363920	CAT CLAW ^{#8}	MARICOPA	7N	3W	13
13	363921	CAT CLAW ^{#9}	MARICOPA	7N	3W	13

Form MCF114
Revised June 2005

This form is available from the Arizona Department of Mines & Mineral Resources and may be reproduced.

RE/9/14/05

United States Department of the Interior
Bureau of Land Management
 BUSINESS & SUPPORT SVCS DIV
 222 N CENTRAL AVE
 PHOENIX, AZ 85004 -2203
 Phone: (602) 417-9200

Receipt	
No:	1141627

Transaction #: 1180866
Date of Transaction: 08/30/2005

CUSTOMER: BEVERLY M BROWN
 10502 CHERRY TREE LN
 SUN CITY, AZ 85373

AMC 266964
 AMC 268020
 AMC 277387
 AMC 354046
 AMC 356328
 AMC 362141
 AMC 353844
 AMC 355354
 AMC 355375
 AMC 358408
 AMC 351675
 AMC 353269
 AMC 363920

LINE #	QTY	DESCRIPTION	REMARKS	UNIT PRICE	TOTAL
1	1.00	LOCATABLE MINERALS / MINING CLAIMS-NOT NEW-UNADJUD, ONE AUTH NO. ONLY / MINING CLAIM MONEY RECEIVED (455) CASES: AMC266964/\$4000.00	MAINT 2006/32	- n/a -	4000.00
TOTAL:					\$4,000.00

RE 9/14/05

PAYMENT INFORMATION

NOTE: Items will appear on credit card statement as "Bureau of Land Management".

1	AMOUNT:	\$1,665.00	POSTMARKED:	N/A
	TYPE:	CREDIT CARD	RECEIVED:	08/30/2005
	NAME:	BROWN, BEVERLY M 10502 CHERRY TREE LN SUN CITY AZ 85373		
	CARD NO:	XXXXXXXXXXXX2786	AUTH CODE:	008232
	NAME ON CARD:	BROWN/BEVERLY		
	EXPIRES:	04/30/2008		
	SIGNATURE:			
2	AMOUNT:	\$1,335.00	POSTMARKED:	N/A
	TYPE:	CHECK	RECEIVED:	08/30/2005
	CHECK NO:	3467		
	NAME:	BROWN, BEVERLY M 10502 CHERRY TREE LN SUN CITY AZ 85373		
3	AMOUNT:	\$1,000.00	POSTMARKED:	N/A
	TYPE:	CHECK	RECEIVED:	08/30/2005
	CHECK NO:	1001		
	NAME:	BROWN, BEVERLY M 10502 CHERRY TREE LN SUN CITY AZ 85373		

REMARKS

This receipt was generated by the automated BLM Collections and Billing System and is a paper representation of a portion of the official electronic record contained therein.

NOTICE!!

These documents have been scanned!

Do not place un-scanned documents beneath this notice!

Do not remove this notice from this file!

GPO Jacket No. 560-102
Print Order 61540
Rise Business Services, LLC
Job=AZ15 6/26/2019



Box Number= AZ15132



Claim Begin-End: AMC363920-AMC363923

5 Miscellaneous



AZ15132-4 AMC363477-AMC364145

**NO
DOCUMENTS
FOUND**

NO DOCUMENTS FOUND
NO DOCUMENTS FOUND

NOTICE!!

These documents have been scanned!

Do not place un-scanned documents beneath this notice!

Do not remove this notice from this file!

GPO Jacket No. 560-102
Print Order 61540
Rise Business Services, LLC
Job=AZ15 6/26/2019



Box Number= AZ15132



Claim Begin-End: AMC363920-AMC363923

6 Location Notices-Amendments and Supporting Documents



AZ15132-4

AMC363477-AMC364145

MINING CLAIM STATUS REPORT

STATUS:

MTP CHECKED BY HMC

GEO CHECKED BY HMC

PRE-ADJ BY HMC

FINAL ADJ BY 1/31/05 AB

LEAD SERIAL NO. AMC 363980 THROUGH AMC 363923

# <u>4</u>	LODE	@ \$30 = \$	<u>120</u>	LOCATION FEE
#	PLACER	@ \$10 = \$	<u>40</u>	SERVICE FEE
#	MILL SITE	@ \$125 = \$	<u>500</u>	MAINTENANCE FEE
#	TUNNEL SITE	\$		OTHER FEES
#	ASSOCIATION PLACER	\$	<u>660</u>	TOTAL

OVER-THE-COUNTER MAIL TIMELY FILED: YES NO

LEGAL DESCRIPTION: T 7N R 3W SECTIONS 10, 13
 T _____ R _____ SECTIONS _____
 T _____ R _____ SECTIONS _____
 T _____ R _____ SECTIONS _____

GENERAL JURISDICTION BLM (OR) NATIONAL FOREST

WILDERNESS AREA: YES NO

SPLIT ESTATE: SX PX SRHA OTHER

PROPER NOTICE FILED IF LOCATING ON SRHA LANDS: YES NO

RECONVEYED MINERALS ON BLM LANDS REQUIRE OPENING ORDERS FROM 1944 TO 1993. OPEN TO ENTRY ON: _____

SUBJECT TO PL 359: YES NO

STATUS: VOID PARTIALLY VOID
PRIVATE MINERALS WITHDRAWN LANDS OTHER

CLAIMANT ACKNOWLEDGES THAT PORTIONS OF THE FOLLOWING CLAIM(S)/SITE(S): _____

MAY BE VOID OR VOIDABLE. Signature of Claimant: _____

COMMENTS: _____

MAP OF MINING CLAIM LOCATION

- The name of the claim Old Mill #1
- The NW corner of the claim is 1,500 feet in a NE direction to a survey monument or permanent object as described as 2" PVC / ROCK
- The type of location monument is 2" PVC / ROCK
- The bearing and distance between the corners of the claim are beginning at the NW corner of the claim, 1,500 feet in a NE direction to the NE corner, then 600 feet in a SE direction to the SE corner, then 1,500 feet in a SW direction to the SW corner, then 600 feet in a NW direction to the point of beginning.
- Please indicate the distance and bearings between claim corners and a recognized survey monument or landmark. Indicate the distance from the location monument to each end of the claim.

MAP

One Inch = One Thousand Feet

North Arrow



One Mile

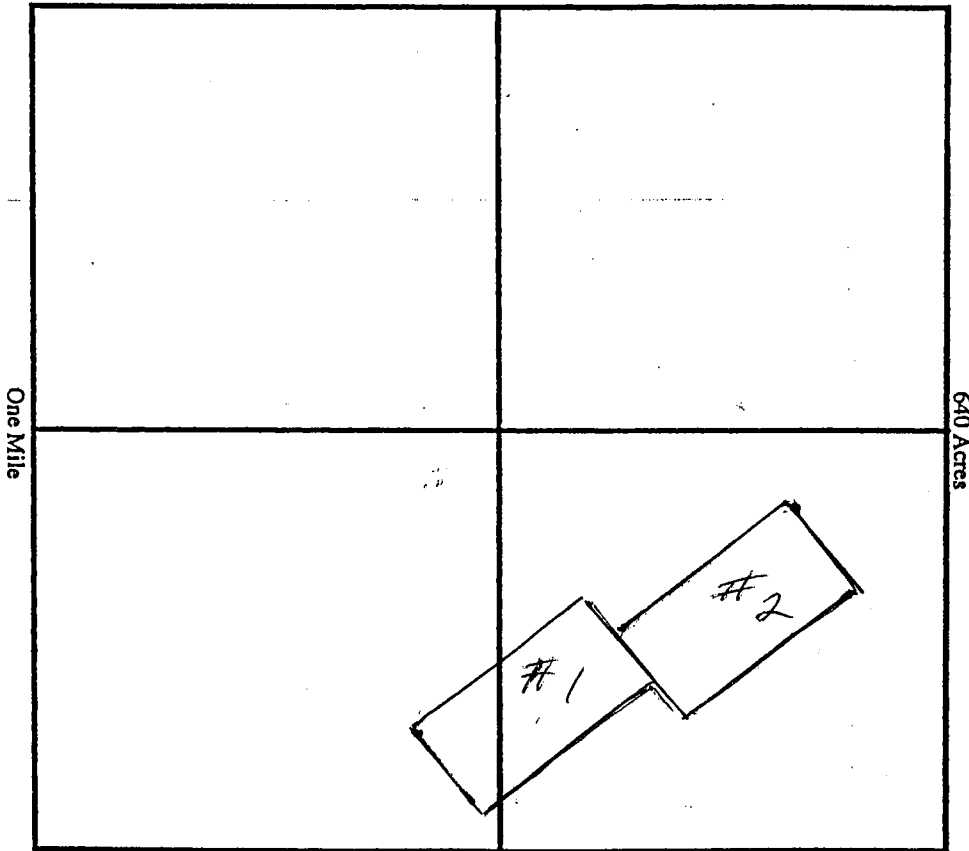

Section 10, Quarter Section S.E, Range 3W,
 Township 7N, G&SR Meridian, YAVAPAI County, Arizona.

Date October 1, 2004 Signature Dennis R. K...
Beverly M. Brown

NOTICE OF MINING CLAIM LOCATION

RECEIVED
B.L.M. AZ STATE OFFICE
2004 DEC 22 A 9:24
PHOENIX, ARIZONA

1. TYPE OF NOTICE: Location Amendment Relocation
2. TYPE OF CLAIM OR SITE: Placer Lode Millsite Tunnelsite
3. The name, address and telephone number of the name(s) to be considered owner(s):
PLEASE PRINT (show additional owners on attached sheet)
Name: BEVERLY M. BROWN & DAVID R. KINZENBACH
Address: 10502 Cherry Tree LN
City/State/Zip Code: SUN CITY, AZ, 85373
Telephone Number (include area code): 623-972-0057
4. The name of the claim: Old Mill # 1
5. The date of location is: October 1, 2004
6. The claim is 1,500 feet long and 600 feet wide. The distance from the location monument to each end of the claim is 1,500 feet in a NE direction and 600 feet in a SE direction.
7. The NW corner of the claim is 1,500
from a survey monument or permanent natural object described as PVC / Rock Monument
8. The general course of the claim is from the NW to the NE
9. The location of the claim is in Section(s) 10, Quarter Section(s) SE/SW, Township(s) 7N, Range(s) 3W, Gila and Salt River Meridian, yavapai County, State of Arizona.
10. Is the claim filed under Public Law 359? yes no
11. Monument types are 2" PVC / Rock

Date October 1, 2004 Signature David R. Kinzenbach Locator Agent Only
Beverly M. Brown

003977

NOTICE OF MINING CLAIM LOCATION

1. TYPE OF NOTICE: Location Amendment Relocation

2. TYPE OF CLAIM OR SITE: Placer Lode Millsite Tunnelsite

3. The name, address and telephone number of the name(s) to be considered owner(s) is: PLEASE PRINT (show additional owners on attached sheet)

Name: Beverly M. Brown & David R. Kinzen BAU
Address: 10502 Cherry Tree LN
City/State/Zip Code: Sun City AZ, 85373
Telephone Number (include area code): 623-972-0057

4. The name of the claim: Old Mill #2

5. The date of location is: October 1, 2004

6. The claim is 1500 feet long and 600 feet wide. The distance from the location monument to each end of the claim is 1500 feet in a NE direction and 600 feet in a SE direction.

7. The NW corner of the claim is 1,500 from a survey monument or permanent natural object described as PVC/Rock Monument

8. The general course of the claim is from the NW to the NE

9. The location of the claim is in Section(s) 10, Quarter Section(s) SE, Township(s) 7N, Range(s) 3W, Gila and Salt River Meridian, Yavapai County, State of Arizona.

10. Is the claim filed under Public Law 359? yes no

11. Monument types are 2" PVC/Rocks

Date: October 1, 2004 Signature: Beverly M. Brown Locator Agent Only

RECEIVED B.L.M. AZ STATE OFFICE 2004 DEC 22 A PHOENIX, ARIZONA

AMC 363923

MAP OF MINING CLAIM LOCATION

1. The name of the claim is Old Mill #2
2. The NW corner of the claim is 1,500 feet in a NE direction to a survey monument or permanent object as described as 2" PVC/ROCK
3. The type of location monument is 2" PVC/ROCK
4. The bearing and distance between the corners of the claim are beginning at the NW corner of the claim, 1,500 feet in a NE direction to the NE corner, then 600 feet in a SE direction to the SE corner, then 1,500 feet in a SW direction to the SW corner, then 600 feet in a NW direction to the point of beginning.
5. Please indicate the distance and bearings between claim corners and a recognized survey monument or landmark. Indicate the distance from the location monument to each end of the claim.

One Inch = One Thousand Feet

One Mile

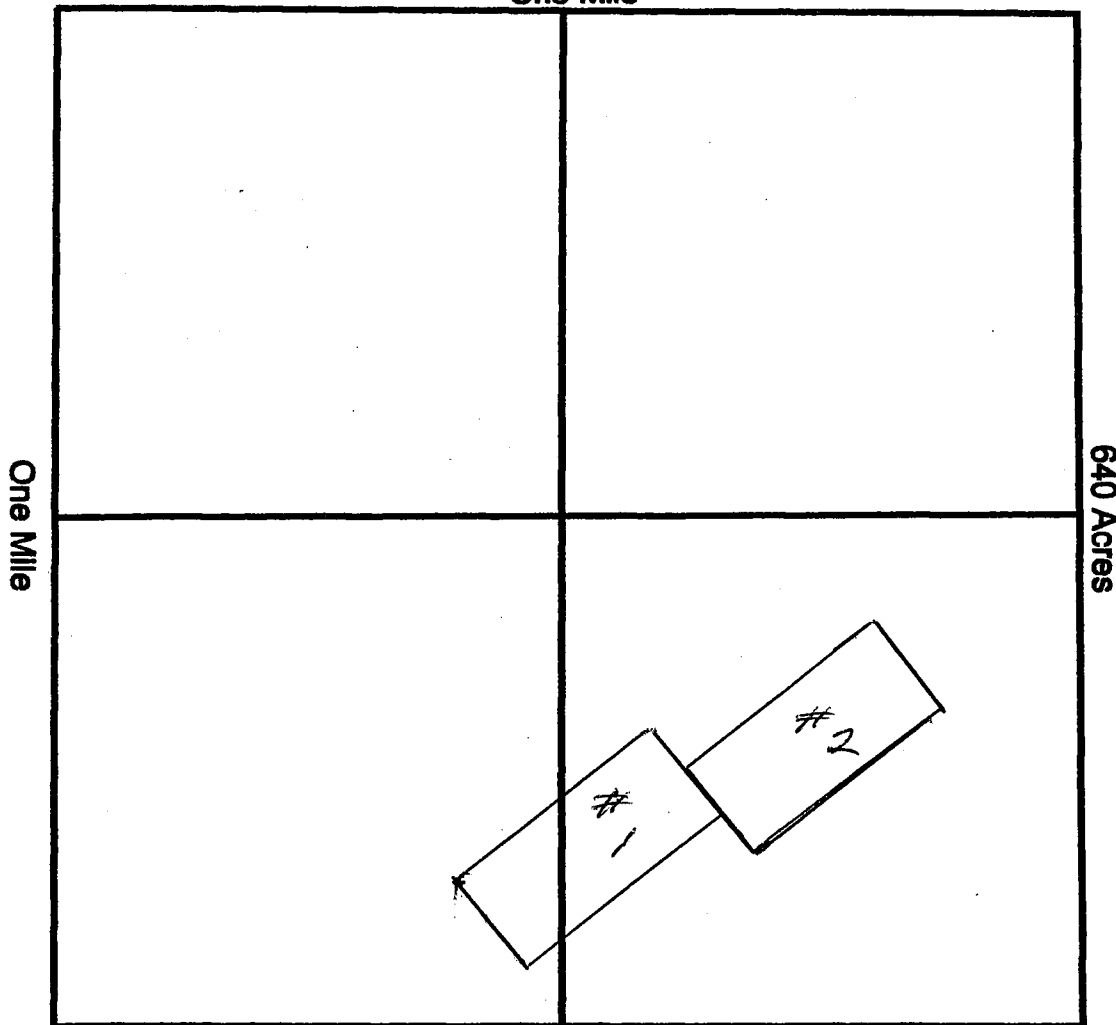

Section 10, Quarter Section S.E., Range 3W,
Township 7N, G&SR Meridian, YAVAPAI County, Arizona.

Date October 1, 2004

Signature Darwin R. Ke...
Beverly M. Brown

NOTICE OF MINING CLAIM LOCATION

RECEIVED
B.L.M. AZ STATE OFFICE
2004 DEC 22 A 9:34 AM
PHOENIX, ARIZONA

ANG 363920

1. TYPE OF NOTICE: Location Amendment Relocation
2. TYPE OF CLAIM OR SITE: Placer Lode Millsite Tunnelsite
3. The name, address and telephone number of the name(s) to be considered owner(s)
PLEASE PRINT (show additional owners on attached sheet)
Name: BEVERLY M. BROWN & DAVID R KINZ
Address: 10502 Cherry Tree Ln.
City/State/Zip Code: SUN CITY, AZ, 85373
Telephone Number (include area code): 623-972-0057
4. The name of the claim: CATCLAW #8
5. The date of location is: October 1, 2004
6. The claim is 1,500 feet long and 600 feet wide. The distance from the location monument to each end of the claim is 1,500 feet in a East direction and 600 feet in a South direction.
7. The NW corner of the claim is 600' South
from a survey monument or permanent natural object described as PVC / Rock Marker Monument located at the NW corner of claim
8. The general course of the claim is from the NW to the NE
9. The location of the claim is in Section(s) 13, Quarter Section(s) SE
Quarter 13 Township(s) 7 N, Range(s) 3 W, Gila and Salt River Meridian, Yavapai County, State of Arizona.
10. Is the claim filed under Public Law 359? yes no
11. Monument types are 2" PVC / Rock Monument

Date October 1, 2004 Signature David R Kinz Locator Agent Only
Beverly M. Brown

MAP OF MINING CLAIM LOCATION

- The name of the claim Pat Claw # 8
- The NW corner of the claim is 1,500 feet in a NE direction to a survey monument or permanent object as described as PVC/ROCK MONUMENT
- The type of location monument is PVC/ROCK
- The bearing and distance between the corners of the claim are beginning at the NW corner of the claim, 1,500 feet in a East direction to the NE corner, then 600 feet in a South direction to the SE corner, then 1,500 feet in a SW direction to the SW corner, then 600 feet in a North direction to the point of beginning.
- Please indicate the distance and bearings between claim corners and a recognized survey monument or landmark. Indicate the distance from the location monument to each end of the claim.

MAP

One Inch = One Thousand Feet

North Arrow



One Mile

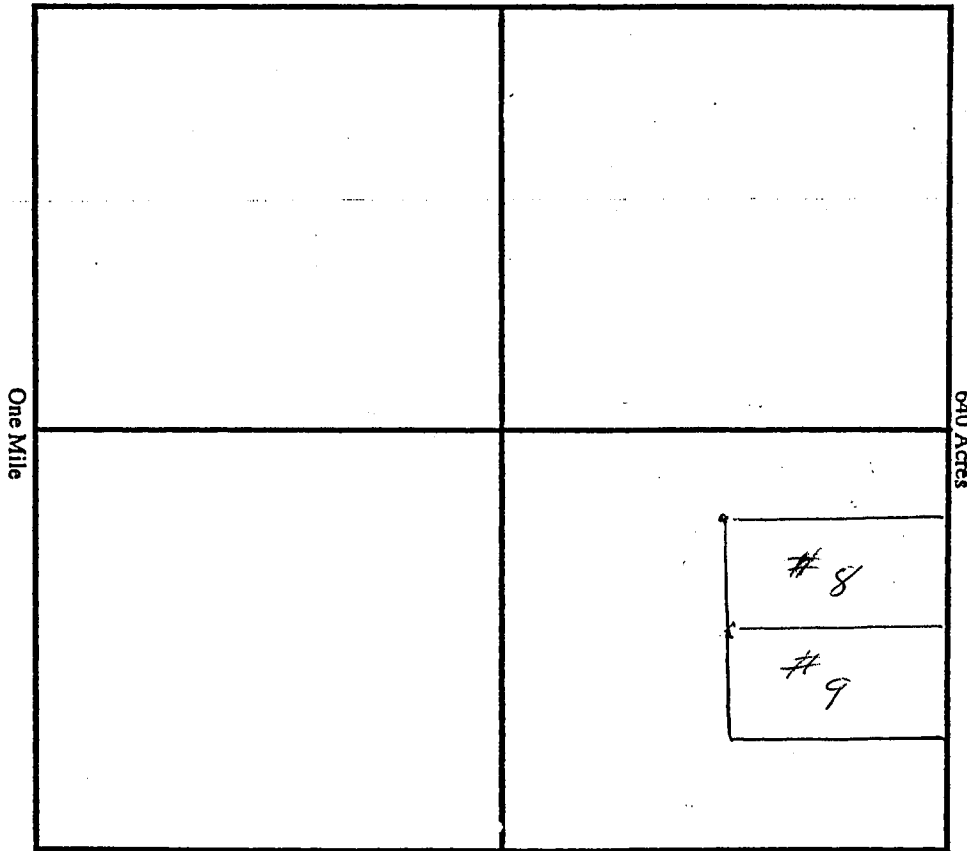

Section 13, Quarter Section S. E., Range 3W
 Township 7 N, G&SR Meridian, YAVAPIA County, Arizona.

Date October 1, 2004

Signature Daniel A. King

Beverly M. Brown

NOTICE OF MINING CLAIM LOCATION

1. TYPE OF NOTICE: Location Amendment Relocation

2. TYPE OF CLAIM OR SITE: Placer Lode Millsite Tunnelsite

3. The name, address and telephone number of the name(s) to be considered owner(s):
PLEASE PRINT (show additional owners on attached sheet)

Name: Beverly M. Brown & David R. Kinzner
Address: 10502 Cherry Tree Ln.
City/State/Zip Code: SUN City, AZ. 85373
Telephone Number (include area code): 623-972-0057

RECEIVED
B.L.M. AZ STATE OFFICE
2004 DEC 22 AM 11:16
PHOENIX, ARIZONA

4. The name of the claim: Catclaw #9

5. The date of location is: October 1, 2004

6. The claim is 1,500 feet long and 600 feet wide. The distance from the location monument to each end of the claim is 1,500 feet in a East direction and 600 feet in a South direction.

7. The NW corner of the claim is 600' South

from a survey monument or permanent natural object described as PVC / Rock Marker Monument located at the NW corner of claim.

8. The general course of the claim is from the NW to the NE.

9. The location of the claim is in Section(s) 13, Quarter Section(s) SE
Quarter 13 Township(s) 7 N, Range(s) 3 W, Gila and Salt
River Meridian, Yavapai County, State of Arizona.

10. Is the claim filed under Public Law 359? yes no

11. Monument types are 2" PVC / Rock Monument

Date October 1, 2004 Signature David R. Kinzner Locator Agent Only
Beverly M. Brown

AM 563921

- The name of the claim Natclaw #9
- The NW corner of the claim is 1,500 feet in a NE direction to a survey monument or permanent object as described as PVC/ROCK MONUMENT
- The type of location monument is PVC/ROCK
- The bearing and distance between the corners of the claim are beginning at the NW corner of the claim, 1,500 feet in a EAST direction to the NE corner, then 600 feet in a South direction to the SE corner, then 1,500 feet in a SW direction to the SW corner, then 600 feet in a North direction to the point of beginning.
- Please indicate the distance and bearings between claim corners and a recognized survey monument or landmark. Indicate the distance from the location monument to each end of the claim.

One Inch = One Thousand Feet

One Mile

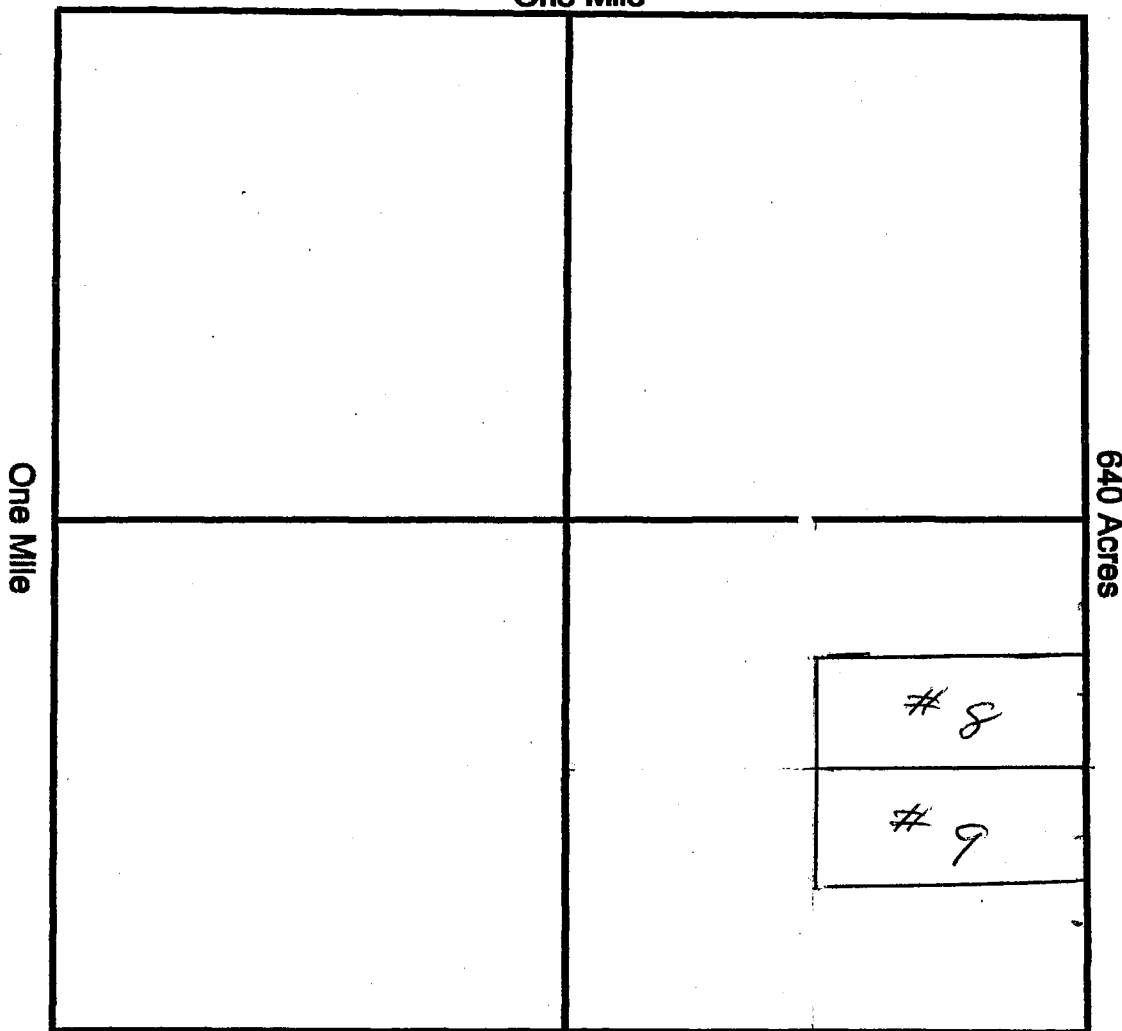

Section 13, Quarter Section SE, Range 3W,
 Township 7N, G&SR Meridian, YAVAPAI County, Arizona.

Date October 1, 2004

Signature Daniel R. King
Leverly Brown

UNITED STATES DEPARTMENT OF INTERIOR
 BUREAU OF LAND MANAGEMENT
 GEOGRAPHIC CROSS REFERENCE
 Sorted by Meridian Township Range

Admin State: AZ

Geo State: AZ

Mer Twp Rng: 14 0070N 0030W

<u>Serial Number</u>	<u>Casetype</u>	<u>Disposition</u>	<u>Actn Code</u>	<u>Actn Txt</u>	<u>Date</u>	<u>Action Remarks</u>
AZA 015036	311111	CLOSED	970	CASE CLOSED	03/01/1985	Total Acres = 7343
ENERGY RESERVES GRP		BOX 1407		DENVER	CO 80201	100.00000 LESSEE

<u>Section</u>	<u>Sur Nr</u>	<u>Sur Suffix</u>	<u>Sur Type</u>	<u>Aliquot Part</u>
010			LOTS	1,2;
010		1	ALIQ	S2NE,S2;
010		2	ALIQ	NW;
013			ALIQ	NENE,NWNW,S2N2,S2;
013			LOTS	1,2;

<u>Serial Number</u>	<u>Casetype</u>	<u>Disposition</u>	<u>Actn Code</u>	<u>Actn Txt</u>	<u>Date</u>	<u>Action Remarks</u>
AZA 023541	837000	CLOSED	970	CASE CLOSED	05/17/1996	Total Acres = 0.001
WICKENBURG HORSEMANS		BOX 21005		WICKENBURG	AZ 85358	100.00000 PERMITTEE

<u>Section</u>	<u>Sur Nr</u>	<u>Sur Suffix</u>	<u>Sur Type</u>	<u>Aliquot Part</u>
010		1	FF	PORTION OF BLM LAND;

<u>Serial Number</u>	<u>Casetype</u>	<u>Disposition</u>	<u>Actn Code</u>	<u>Actn Txt</u>	<u>Date</u>	<u>Action Remarks</u>
AZA 025689	380913	CLOSED	970	CASE CLOSED	07/15/1996	Total Acres = 1
ANDERSON SIDNEY		602 W UNIV DR		MESA	AZ 85201	100.00000 OPERATOR
ANDERSON SIDNEY		602 W UNIV DR		MESA	AZ 85201	0.00000 CLAIMANT

<u>Section</u>	<u>Sur Nr</u>	<u>Sur Suffix</u>	<u>Sur Type</u>	<u>Aliquot Part</u>
010		1	FF	PART;

<u>Serial Number</u>	<u>Casetype</u>	<u>Disposition</u>	<u>Actn Code</u>	<u>Actn Txt</u>	<u>Date</u>	<u>Action Remarks</u>
AZA 025695	380913	CLOSED	970	CASE CLOSED	07/15/2002	Total Acres = 1

UNITED STATES DEPARTMENT OF INTERIOR
 BUREAU OF LAND MANAGEMENT
 GEOGRAPHIC CROSS REFERENCE
 Sorted by Meridian Township Range

COOK GEORGE E	HC 65 BOX 6001	CONCHO	AZ 85924	100.00000	OPERATOR
COOK GEORGE E	HC 65 BOX 6001	CONCHO	AZ 85924	0.00000	CLAIMANT

<u>Section</u>	<u>Sur Nr</u>	<u>Sur Suffix</u>	<u>Sur Type</u>	<u>Aliquot Part</u>
013		1	FF	PART;

<u>Serial Number</u>	<u>Casetype</u>	<u>Disposition</u>	<u>Actn Code</u>	<u>Actn Txt</u>	<u>Date</u>	<u>Action Remarks</u>
AZA 025724	380913	CLOSED	970	CASE CLOSED	04/19/2001	Total Acres = 1

US BORAX & CHEMICAL	1802 W GRANT RD #108	TUCSON	AZ 85745	100.00000	CLAIMANT
US BORAX & CHEMICAL	1802 W GRANT RD #108	TUCSON	AZ 85745	0.00000	OPERATOR

<u>Section</u>	<u>Sur Nr</u>	<u>Sur Suffix</u>	<u>Sur Type</u>	<u>Aliquot Part</u>
013		1	FF	PART;

<u>Serial Number</u>	<u>Casetype</u>	<u>Disposition</u>	<u>Actn Code</u>	<u>Actn Txt</u>	<u>Date</u>	<u>Action Remarks</u>
AZA 025974	380913	CLOSED	970	CASE CLOSED	04/19/2001	Total Acres = 1

PARSONS GLEN	BOX 349	MORRISTOWN	AZ 85342	100.00000	OPERATOR
PARSONS GLEN	BOX 349	MORRISTOWN	AZ 85342	0.00000	CLAIMANT

<u>Section</u>	<u>Sur Nr</u>	<u>Sur Suffix</u>	<u>Sur Type</u>	<u>Aliquot Part</u>
013		1	FF	PART;

<u>Serial Number</u>	<u>Casetype</u>	<u>Disposition</u>	<u>Actn Code</u>	<u>Actn Txt</u>	<u>Date</u>	<u>Action Remarks</u>
AZA 028092	380913	CLOSED	970	CASE CLOSED	04/19/2001	Total Acres = 1

PARSONS GLEN	BOX 349	MORRISTOWN	AZ 85342	100.00000	OPERATOR
PARSONS REBECCA	BOX 349	MORRISTOWN	AZ 85342	0.00000	CLAIMANT

<u>Section</u>	<u>Sur Nr</u>	<u>Sur Suffix</u>	<u>Sur Type</u>	<u>Aliquot Part</u>
013		1	FF	PORTION OF N2;

<u>Serial Number</u>	<u>Casetype</u>	<u>Disposition</u>	<u>Actn Code</u>	<u>Actn Txt</u>	<u>Date</u>	<u>Action Remarks</u>
AZA 030984	380913	CLOSED	970	CASE CLOSED	12/02/2002	Total Acres = 3

MINER ARTISTS OF AMERICA	HC 68, BOX 1509	KIRKLAND	AZ 86332	100.00000	OPERATOR
MINER ARTISTS OF AMERICA	HC 68, BOX 1509	KIRKLAND	AZ 86332	0.00000	CLAIMANT

UNITED STATES DEPARTMENT OF INTERIOR
 BUREAU OF LAND MANAGEMENT
 GEOGRAPHIC CROSS REFERENCE
 Sorted by Meridian Township Range

<u>Section</u>	<u>Sur Nr</u>	<u>Sur Suffix</u>	<u>Sur Type</u>	<u>Aliquot Part</u>
010			ALIQ	SESW;
010			ALIQ	SWSE;

<u>Serial Number</u>	<u>Casetype</u>	<u>Disposition</u>	<u>Actn Code</u>	<u>Actn Txt</u>	<u>Date</u>	<u>Action Remarks</u>
AZA 031266	380913	CLOSED	970	CASE CLOSED	05/15/2000	Total Acres = 1
UNKNOWN TRESPASSER		21605 N 7TH AVE		PHOENIX	AZ 850272099	100.00000 PARTY-IN-INTEREST

<u>Section</u>	<u>Sur Nr</u>	<u>Sur Suffix</u>	<u>Sur Type</u>	<u>Aliquot Part</u>
010			ALIQ	SW;

<u>Serial Number</u>	<u>Casetype</u>	<u>Disposition</u>	<u>Actn Code</u>	<u>Actn Txt</u>	<u>Date</u>	<u>Action Remarks</u>
AZA 031568	837000	AUTHORIZED	279	PMT-LIC RENEWED	01/09/2003	Total Acres = 1
BC JEEP TOURS		58558 RANCHO CASITAS RD		WICKENBURG	AZ 85390	100.00000 PERMITTEE

<u>Section</u>	<u>Sur Nr</u>	<u>Sur Suffix</u>	<u>Sur Type</u>	<u>Aliquot Part</u>
010			FF	PORTION OF;

<u>Serial Number</u>	<u>Casetype</u>	<u>Disposition</u>	<u>Actn Code</u>	<u>Actn Txt</u>	<u>Date</u>	<u>Action Remarks</u>
AZA 031882	837000	EXPIRED	234	EXPIRED	02/09/2004	Total Acres = 1
ARIZONA TRAIL RIDERS		BOX 31877		PHOENIX	AZ 85046	100.00000 PERMITTEE

<u>Section</u>	<u>Sur Nr</u>	<u>Sur Suffix</u>	<u>Sur Type</u>	<u>Aliquot Part</u>
013			ALIQ	NW;

<u>Serial Number</u>	<u>Casetype</u>	<u>Disposition</u>	<u>Actn Code</u>	<u>Actn Txt</u>	<u>Date</u>	<u>Action Remarks</u>
AZA 031938	380913	CLOSED	970	CASE CLOSED	06/17/2002	Total Acres = 1
COMPTON KALEB		10502 CHERRY TREE LN		SUN CITY	AZ 85373	100.00000 OPERATOR
COMPTON KALEB		10502 CHERRY TREE LN		SUN CITY	AZ 85373	0.00000 CLAIMANT

<u>Section</u>	<u>Sur Nr</u>	<u>Sur Suffix</u>	<u>Sur Type</u>	<u>Aliquot Part</u>
010			ALIQ	SW;

<u>Serial Number</u>	<u>Casetype</u>	<u>Disposition</u>	<u>Actn Code</u>	<u>Actn Txt</u>	<u>Date</u>	<u>Action Remarks</u>
----------------------	-----------------	--------------------	------------------	-----------------	-------------	-----------------------

UNITED STATES DEPARTMENT OF INTERIOR
BUREAU OF LAND MANAGEMENT
GEOGRAPHIC CROSS REFERENCE
Sorted by Meridian Township Range

AZA 031961 837000 AUTHORIZED 276 PMT-LIC ISSUED 02/22/2002 Total Acres = 1
OHV FUN RUNS LLC 5244 E FOREST PLEASANT PL CAVE CREEK AZ 85331 100.00000 PERMITTEE

<u>Section</u>	<u>Sur Nr</u>	<u>Sur Suffix</u>	<u>Sur Type</u>	<u>Aliquot Part</u>
010			FF	PORTION OF;
013			FF	PORTION OF;

